



VanDusen
BOTANICAL GARDEN

Bloedel
CONSERVATORY

Vancouver
Botanical
Gardens
Association

WITH GROWING HEARTS!

Celebrating Canada's 150th birthday

VANDUSEN PLANT SALE

Sunday, April 30th, 10 am - 4 pm

Catalogue

\$2

Welcome to the VanDusen Garden 39th Annual Plant Sale

Celebrating Canada's 150th Birthday

Our 2017 Plant Sale Catalogue will help you explore the thousands of plants available at this year's sale. Carefully assembled information on this vast array of plants will help you choose the perfect additions to your gardens, decks and patios.

This year, we are celebrating Canada's birthday! We want to encourage everyone to have their garden pop this year with Canada's red and white colours. From the beautiful white *Dicentra spectabilis* 'Alba' (white bleeding heart) to *Monarda didyma* (scarlet flowered bee balm) there is something here for every patriotic gardener.

Many thanks to over 400 hardworking volunteers who dedicate thousands of hours and all of their gardening wisdom to make this sale such a success.

We are proud to continue our tradition of making a substantial financial contribution to VanDusen Botanical Garden.

Let's celebrate Canada's birthday together!

Margaret Lord,
Plant Sale Chair 2017

We wish to thank our sponsors and vendors for their support:

MedTech EMS Doug House; Nusa Coffee Co.; Pepsi Cola Canada Ltd.; Salmon's Rentals Ltd.;
Scouts Canada; Way To Grow.

Alouette Nursery; Andrew Watson Snap Pea Catering; Brock House; Canadian Springs Co. Ltd.; Canadian Tire (Cambie & 6th);
Crêperie La Bohème; DeVry Greenhouses Ltd.; Dovbush Perogies; Eli's Serious Sausage; Erica Enterprises Ltd.; GardenWorks;
Michael Welsh The Fruit Guy; Mr. Sharp, Tool Sharpening; Oriental Orchids Ltd.; Pops Predatory Plants; Savary Island Pie Company;
Southlands Nursery; Taisuco Canada; The Bean Buggy Coffee Truck; The Mushroom Man Scott Henderson;
Tropical Gardens Orchids; Van Noort Bulb Co. Ltd.

VANDUSEN BOTANICAL GARDEN

PLANT SALE CATALOGUE 2017

BERRIES.....	4
FRUIT TREES.....	5
FUCHSIAS AND BEGONIAS.....	6
GERANIUMS (PELARGONIUMS).....	7
ORCHIDS AND EXOTICS.....	7
POT LUCK.....	7
HERBS	8
TOMATOES	10
VEGETABLES.....	10
MUSHROOMS KITS.....	10
SEEDS	11
PERENNIALS.....	12
PACIFIC NORTHWEST NATIVE PLANTS.....	18
RHODODENDRONS AND AZALEAS.....	21
TREES AND SHRUBS	24
VINES.....	32
TROPICALS	33
SUCCULENTS AND CACTI	34

BERRIES

Genus: Rubus	Size	Origin	Bloom	Pick	Description
Latham Raspberry	#1	Minnesota, US	self-fertile	July-Aug	Heirloom variety, full flavour, sweet, tangy, cold hardy, red fall colour
Genus: Vaccinium					
Spartan Blueberry	#1 pot		psf	July-Aug	Attractive, large, tasty fruit, ripens early. Good fall colour
Duke Blueberry	#1 pot	Maryland, NJ	psf	July-Aug	Large flavourful berry, sugars increase in freezing
Summer Breeze 3-in-1 Blueberry	#5 pot		sf	July-Aug	3 cultivars in one pot for maximum pollination, perfect for patios
Sweetheart Blueberry	#1 pot	NJ, 2010	psf	June-Aug	Two crops in mild winter years
Reka Blueberry	#1 pot	New Zealand	psf	July-Aug	Upright growth habit, dark flavourful berries
<i>Vaccinium myrtilloides</i> (Velvet Leaf Blueberry)	#1 pot	Native to Canada and US	sf	July-Aug	Forms low, dense mat in a dappled shade setting. One of the sweetest blueberries
<i>Vaccinium angustifolium</i>	#1 pot	Native to Canada and US	sf	July-Aug	Forms low, dense mat in dapples shade setting. Sweet tangy, wild-blueberry flavour. Beautiful fall colour
Genus: Lonicera					
<i>Lonicera caerulea</i> 'Borealis'	#2 pot	Sask., Canada		June	Most highly rated. Flavour between raspberry and huckleberry
<i>Lonicera kamchatica</i> 'Berry Blue'	#2 pot	Sask., Canada		June	Good flavour, excellent
Summer Breeze 3-in-1 Lonicera	#3 pot		sf	June	Three varieties in one pot.
Genus: Ribes					
<i>Ribes nigrum</i> 'Ben Nevis' Blackcurrant	#2 pot		sf	July	Fruit med with high vitamin C, excellent for juice/jelly
<i>Ribes rubrum</i> 'Red Lake' Redcurrant	#2 pot		sf	early July	Fruit med red tangy, vitamin C, excellent for juice/jelly
<i>Ribes uva-crispa</i> 'Black Velvet'	#1 pot		sf	June-July	Fruit smaller, dark red-black, sweet almost blueberry flavour
<i>Ribes uva-crispa</i> 'Welcome'	#2 pot		sf	June-July	Large, green sweet-tart fruit, more shade tolerant than other gooseberries
Genus: Sambucus					
<i>Lacinata</i> American elderberry	#1 pot	USA	sf	August	Showy, compact, attracts wildlife, medicinal, good for wine/juice/jelly
Genus: Rheum					
Strawberry-Red Rhubarb	#1 pot		sf	spring	Bright red stalks with mild rhubarb flavour
Genus: Lycium					
Goji Berry	#1	China	sf	June-Aug	Juicy sweet bright red berries. Tall, wide habit.

trip = pollen sterile, sf = self-fertile, psf = partially self-fertile

The flower of the **Western flowering dogwood**, *Cornus nuttallii*, is the provincial floral emblem of British Columbia. It is the only such emblem that is the flower of a tree; the other nine provincial emblems are flowers of shrubs or perennials. Western flowering dogwood was selected as the emblem in 1959 and it is now an iconic image on many BC products. The image is composed not of flower petals but of the white, modified leaves called bracts that surround much smaller flower parts.

FRUIT TREES

Variety	R/s	Origin	Bloom	Pick	Description	Additional
Genus: Malus (Apple)						
Ard Cairn Russet	M26	Ireland c1890	Mid	September	Med, orange-red flush w russet, sweet, banana-like	res to scab
Arlet	MM111	Switzerland 1984	Early	Sept-Oct	Med-large, bright red, flavour good, bears young	
Bottle Greening	MM106	NY-VT 1800s	Early	October	Med-large, grassy-green flushed pink, sweet-sharp, juicy	
Bramley's Seedling	M9	Notts 1809	Mid *trip*	October	Large, green, sharp, juicy, firm for cooking, juice, cider	
Chenango Strawberry	MM106	USA c1850	Mid	September	Med, pale yellow striped red, sweet-sharp, sl. strawberry	
Lodi	M9	New York 1911	Early	Early Aug	Med, pale yellow, white, soft, very juicy	res to scab
Lord Lambourne	MM111	UK 1907	Mid psf	Mid Sept	Med, green-yellow w bright red flush, sl. strawberry	
Lyman's Large Summer	MM111	Ontario 1847	Early?	Aug	Large, green-yellow, sweet-sharp, juicy, crisp	
North West Greening	M26	Wisconsin 1872	Late	October	Large, yellow-green, quite sweet, juicy, firm, sl. aromatic	
Pomme d'Api aka 'Lady'	M9	France 1628	Early-mid	October	Small, yellow brightly fl red, sweet, juicy, crisp, aromatic	
Red Astrachan	M26	Russia	v early	August	Med, deep crimson, bloomy, sweet-sharp, juicy, crisp	res to scab
Summer Rambo	MM106	France 1535	Mid *trip*	August	Large, yellow-green striped pink, sweet, juicy, firm,	also for cider
Genus: Malus (Crab apple)						
Snowdrift crabapple	M26	USA 1965	mid	September	Ornamental & pollenizer, robins love the orange fruit	
Genus: Pyrus (Pear)						
Barland (aka Bosbury)	OHF87	England c1600	mid *trip*	September	Pyriform, yellow w red blush, bittersharp, high vigour	For perry
Butt	OHF 87	England 1884	mid		Bitter-sharp	
Gieser Wildeman	OHF87	Holland 1850	mid	September	Small, pyriform, pink flesh, aka 'stoofperen'	for poaching
Gin	OHF87	England 1880s	mid	October	Broadly turbinate, green w orange flush, medium-sharp	for perry
Sangvinelle (aka Sanguinole?)	OHF 87	Germany 1500s	mid	September	Turbinate-obtuse, flesh transparent w red streaks	for perry
Summer Bloodbine	OHF87	Germany	mid	August	Med, pyriform, pleasant red flesh wth. slight cinnamon	for perry
Thorn	OHF87	England 1676	mid	September	Round-pyriform, yellow w russet, medium-sharp	for perry
Genus: Ficus (Fig)						
<i>Ficus carica</i> 'Brown Turkey'				June	Brownish purple skin with soft pink sweet flesh	
<i>Ficus carica</i> 'Kadoka'				June	Greenish yellow skin with pink sweet flesh	

trip = pollen sterile, sf = self-fertile, psf = partially self-fertile

The Western flowering dogwood, Cornus nuttallii, grows in openings in coastal forests, normally with its crown in the sun and plentiful air flow around its branches, and its roots in moist shade. The species is susceptible in cultivation to the fungal disease, anthracnose, so is important to plant it in sites with its preferred conditions. It is the same with most native plants – they do best cultivated in sites similar to where they naturally grow. There are a few western flowering dogwood plants available for sale in the Pacific Northwest Natives section of the Plant Sale.

FUCHSIAS AND BEGONIAS

Fuchsias bloom from early summer to early autumn, come in thousands of varieties, and are excellent for baskets and planters or planting directly in the garden. Hummingbirds are attracted to nectar from the colourful flowers.

Growing requirements:

Morning sun, dappled or partial shade all day. Grow in moist soil, high in organic matter. Feed with a quick-release water-soluble fertilizer every two weeks.

Hardy fuchsias:

Fuchsia magellanica, F. magellanica 'Aurea', F. 'Riccatoni', F. 'Genii', F. 'Gracilis'

Variegated leaf varieties:

Fuchsia magellanica 'Tricolor'; F. 'Golden Marinka' (yellow leaf); F. 'Autumnell'; F. 'Island Sunset'

Semi-hardy:

Fuchsia 'Otto' - Large, exuberant double flowers with very flared red sepals and purple corollas. Attractive to bees, butterflies and humming birds

Fuchsia 'Winston Churchill' - Flowers are double, with short, reflexed, pink sepals and tube, and bluish-lavender petals

We have an excellent collection of Hardy fuchsias, with various leaf and flower colours, that can grow to 200cms (6ft) here on the lower mainland. Hardy fuchsias grow back late each spring.

Trailers and uprights can be potted into planters and baskets. Pinch back new growth tips until the end of June. This will promote new growth and more flower buds.

To make a basket we recommend using up to eight, 2 ½" plants in a twelve inch basket. Planting all of the same variety in one basket makes a much nicer show.

We have the following varieties available for 2017, plus a good selection of old and new varieties in many colours, with single and double blooms, flower style and sun tolerance.

Fuchsia (Diva Series) 'Midnight', 'Rose and Purple', 'White and Lilac'

Fuchsia 'Garden Meister' - Red tubular-shaped, honeysuckle fuchsia blossoms

Fuchsia 'Marinka' - Scarlet sepals and deep red petals, on this free flowering trailing fuchsia

Fuchsia 'Lottie Hobby' (aka 'Mini False Creek') - Bushy, upright, vigorous plant has very small serrated leaves and small, single flowers with dark pink sepals and tube, and deep pink petals

Fuchsia 'Pink Marshmallow' - Extra large double flowers, with long pale pink tube

Begonias

Fibrous begonias are annual plants. These brightly colored begonias are equally at home in full sun or shade, in containers or garden beds.

Angel Wing begonia is named for the shape of its leaves. With its attractive year round foliage, you can grow an Angel Wing begonia indoors as a houseplant, in bright, indirect light. These cane-type begonias are some of the world's best performing and easiest begonias to grow. They have interesting leaves and magnificent displays of pendant and drooping flowers.

Nonstop begonias can be planted in a flowerbed, hanging basket or patio container, in any well-drained soil.

Solenia begonias - These hiemalis-type begonias have been a popular semi-shade basket plant for years.

The new Solenia series are faster growing, mildew resistant and take full sun, and are a cross between a tuberous begonia and a wax begonia. They are 'self cleaning' and require no deadheading.

Miniature Roses

We have an abundance of miniature roses in all colours, plus some fragrant varieties. These miniature roses can be used in pots, and also do well planted in the garden.

GERANIUMS (PELARGONIUMS)

Zonal geraniums are one of the most easily recognized annuals on the market. They have several distinctive features including almost kidney-shaped leaves that may or may not have darker circular marks on them. Flowers resemble spheres that stand atop sturdy stems. Colours available will be white, pink, salmon, and classic red.

Ivy geraniums, also known as trailing geraniums, are perfect for window boxes and planters. Ivy geraniums bloom continuously all season long with semi-double flowers in colours from white to red to different pastel shades. Flowers are “self-cleaning” so deadheading is not needed.

Geraniums are versatile in the garden, gracing pots or planting beds with low maintenance beauty. On the whole geraniums prefer full sun but will tolerate part shade. Do not overwater. They will bloom all summer right up to the first frost.

We have more varieties of scented geraniums this year including: peppermint-scented geraniums – an all time favourite; lemon-scented geraniums – always popular; pink-champagne geraniums – citrusy scent; and “Prince George” orange-scented geraniums. Scented geraniums are grown for their leaf fragrance rather than their flowers.

ORCHIDS AND EXOTICS

The orchids available at the sale are outstanding indoor plants, with attractive blooms. Some types last for several months at a time. Orchids are far tougher and hardier than most people think, and are mostly extremely adaptable. All orchid plants at the sale come with detailed culture sheets, to provide information on how to nurture them. Here are some examples of the types of orchids that we expect to be available at the sale:

- Phalaenopsis (moth orchid) - this is the most popular type of orchid because the blooms are so long-lasting. There will be a big selection, perfect gifts for birthdays, Mother’s Day or any special occasion. They feature flat, glossy, spreading leaves supporting arching spikes of white, pink, purple, yellow, or spotted/striped blooms.
- Oncidium, a variety of intergenerics - blooms with spikes of fancifully patterned flowers in shades of white, yellow, red and brown.
- Cattleya – several types of plants could be available, depending on what is ‘in spike’ at the time of the sale; large, showy flowers with a variety of colours.
- Dendrobium – a variety of plants could be available, depending on what is ‘in spike’ at the time of the sale; bloom in sprays with delicate florets that are 1 inch to 2 inches across, in an array of colors including purple, pink, fuchsia, white, yellow, green and bicolours.

There will be a large selection of fascinating carnivorous plants, some being hardy outdoor types. Here are some available varieties:

- Sarracenia – this is a large and varied family of North American Pitcher Plants. These incredible plants display a multitude of foliage colours and are winter hardy in the Pacific Northwest. They also eat bugs.
- Dionaea – Venus Fly Traps are the only ‘active’ carnivorous plants.
- Drosera – Sundews are sticky plants, great for trapping fruit flies and fungus gnats in your house or greenhouse.
- Pinguicula – attractive plants with colourful, violet-like flowers.

POT LUCK

Pot Luck has an interesting selection of perennials, trees and shrubs. We have plants for all seasons – astilbes, geraniums, hostas, irises, grasses, ferns, hellebores, hemerocallis, rogersia, peonies, primulas and sedums, to name a few. We have baskets of perennials selected for specific areas (shade or sun), and many pots of succulents for that sunny spot.

Plants have been collected from gardens of members and friends of VanDusen Botanical Garden, some from VanDusen Garden, while other plants are donated by local nurseries. There are many old favourites, and some more unusual offerings. We are not always able to be sure of the colour or exact botanical identity – hence the name Pot Luck.

The Pot Luck group relies on plant donations throughout the year. If you would like to donate plants for next year’s sale, please call Jean McComb at 604.261.4556, or Margie Knox at 604.261.1868.

HERBS

Plant Name	Height	Colour	Bloom	Information
<i>Agastache foeniculum</i> (anise hyssop)	90cm (36in)	lavender	summer	Leaves used for herbal teas. Flowers attractive to bees
<i>Allium sativum</i> (Russian red garlic)	40cm (16in)	lavender	summer	Purple-blotched bulbs, strong flavour
<i>Allium tuberosum</i> (garlic chives)	15cm (6in)	white	summer	Garlic flavour
<i>Aloysia triphylla</i> (lemon verbena)	1m (3ft)	white	e. summer	Fragrant leaves, tender
<i>Aloe vera</i>	30cm (12in)	foliage		Tender succulent, medicinal
<i>Angelica archangelica</i> (angelica)	2m (6ft)	greenish-yellow	e. summer	Medicinal. Used in confectionary
<i>Anthriscus cerefolium</i> (chervil)	40cm (16in)	white	e. summer	Culinary
<i>Artemisia dracunculus</i> var. <i>sativa</i> (French tarragon)	50cm (20in)	blue-green foliage		Culinary
<i>Borago officinalis</i> (bush borage)	90cm (36in)	deep blue	summer	Culinary, hardy annual
<i>Cardamom</i>		foliage		Tropical Asian plant of the ginger family
<i>Coriandrum sativum</i> (coriander, cilantro)	50cms (20in)	white to mauve	summer	Culinary, hardy annual. One of the oldest-known herbs
<i>Foeniculum vulgare</i> (fennel)	2m (6ft)	green-yellow/blue	l. summer	Culinary, leaves or seeds
<i>Foeniculum vulgare</i> 'Purpureum' (bronze fennel)	2m (6ft)	bronze foliage	l. summer	Culinary, leaves or seeds
<i>Fragaria vesca</i> (Alpine strawberries)	hanging bskt.	white	summer	Culinary
<i>Fragaria</i> spp. (ever-bearing strawberries)	hanging bskt.	pink	summer	Culinary
<i>Helichrysum angustifolium</i> (curry plant)	60cm (24in)	grey foliage	summer-fall	Sunny location, well drained
<i>Hierochloe odorata</i> (sweet vanilla grass)	30cm (12in)	glossy foliage	summer-fall	Sweet vanilla scent. Used by native Americans
<i>Levisticum officinale</i> (lovage)	150cms (60in)	yellow	summer	Celery-flavoured, hardy, culinary perennial
<i>Laurus nobilis</i> (sweet bay)	3m (10ft)	dark green foliage		Per. shrub from Mediterranean, leaves used in cooking
<i>Lavandula angustifolia</i> 'Hidcote'	45cm (18in)	deep purple	summer-fall	Small growing form
<i>Lavandula angustifolia</i> 'Munstead'	45cm (18in)	deep purple	summer-fall	Sunny location, well drained
<i>Lavandula angustifolia</i> 'Twickel Purple'	45cm (18in)	rich purple	summer-fall	Long flower stems, rich, sweet aroma
<i>Lavandula angustifolia</i> 'Violet Intrigue'	60cm (24in)	violet	summer	Forms a dense mound. Sunny location, well drained
<i>Lavandula dentata</i> (fringed lavender)	60cm (24in)	purple, pink	e. summer	Sunny location, well drained
<i>Lavandula stoechas</i> 'Anouk'	30cm (12in)	purple	summer-fall	Compact, sunny location, well drained
<i>Lavandula stoechas</i> (French lavender)	60cm (24in)	purple, pink	e. summer	Sunny location, well drained
<i>Lavandula stoechas</i> 'Otto Quast' (Spanish lavender)	60cm (24in)	purple	summer	More prostrate than other varieties, sun, well drained
<i>Lavandula x intermedia</i> 'Alba'	45cm (18in)	white	summer	Compact, snow-white flowers, silver foliage
<i>Lavandula x intermedia</i> cv. 'Fred Boutin'	60cm (24in)	violet	summer-fall	Silver-grey foliage, sunny location, well drained
<i>Lavandula x intermedia</i> 'Grosso'	60cm (24in)	purple	summer-fall	Hardier than other lavenders, sturdy growth habit
<i>Lavandula viridis</i>	45cm (18in)	yellow	summer	Striking contrast for purple lavender
<i>Melissa officinalis</i> (lemon balm)	45cm (18in)	bright green foliage	l. summer	Fragrant leaves, culinary, teas, spreads rapidly from seeds
<i>Mentha arvensis</i> 'Banana'	30cm (12in)	purple	summer	Lime-green foliage. Delightful banana aroma
<i>Mentha piperita</i> (chocolate mint)	30cm (12in)	white	summer	Fun for children to grow. Attracts butterflies
<i>Mentha x piperita</i> (peppermint)	30cm (12in)	purple-tinged foliage	summer	Partial shade, moist soil, can be invasive
<i>Mentha requienii</i> (Corsican mint)	groundcover	purple	summer	Peppermint smell
<i>Mentha x rotundifolia</i> (apple mint)	30cm (12in)	white	summer	Round, hairy leaves, use for flavouring summer drinks
<i>Mentha x villosa</i> (mojito mint)	30cm (12in)	white	summer	Authentic mint, used in Cuba's famed mojito cocktail

HERBS

Plant Name	Height	Colour	Bloom	Information
<i>Mentha spicata</i> (English mint)	45cm (18in)	mauve	summer	Culinary use, as flavouring or in tea
<i>Nepeta cataria</i> (catmint or catnip)	90cm (36in)	blue, white	summer	Attractive to bees as well as cats
<i>Ocimum basilicum</i> (sweet basil)	45cm (18in)	bright green foliage	summer	Culinary, tender annual. Other varieties, Thai and lemon
<i>Ocimum camphorata</i> 'Dark Opal' (purple basil)	38cm (15in)	purple foliage	summer	Culinary, tender annual
<i>Ocimum var. minimum</i> (Greek basil)	20cm (8in)	tiny green foliage	summer	Dwarf variety, pot culture, tender annual
<i>Ocimum basilicum var. thyriflora</i> (Thai basil)	20cm (8in)	narrow leaves, purple flws	summer	Widely used throughout southeast Asia. Spicy flavour
<i>Origanum onites</i> (French or pot marjoram)	groundcover	bright green foliage	l. summer	Culinary, mild
<i>Origanum majorana</i> (sweet marjoram)	groundcover	white flowers	l. summer	Culinary. Mix of sweet pine and citrus flavour
<i>Origanum vulgare</i> 'Aureum'	groundcover	yellow-green foliage	l. sum-fall	Culinary, decorative
<i>Origanum vulgare</i> subsp. <i>hirtum</i> (Greek oregano)	60cm (24in)	pink, white	summer	Culinary, strong flavour. Compact habit
<i>Pelargonium</i> (scented geranium)	30cm (12in)	pink or white	summer	Easy to grow, fragrant and attractive plants
<i>Perilla frutescens</i> (shiso green)	45cm (18in)			Asian culinary herb
<i>Perilla frutescens</i> (purple shiso)	45cm (18in)	purple foliage		Asian culinary herb
<i>Petroselinum crispum</i> (curled parsley)	30cm (12in)		summer	Culinary uses, main ingredient in French bouquet garni
<i>Petroselinum crispum</i> 'Italian' (Italian parsley)	30cm (12in)		summer	Culinary uses, flat leaf, with stronger flavour
<i>Polygonum odoratum</i> (Vietnamese coriander)	20cm (8in)			Lemony aroma. Leaves used in Southeast Asian cooking
<i>Pycnanthemum muticum</i> (mountain mint)	90cm (36in)	white	summer	Amazing attraction for most pollinators
<i>Rosmarinus officinalis</i> (rosemary)	60cm (24in)	blue	spring	Culinary uses
<i>Rosmarinus</i> 'Tuscan Blue'	60cm (24in)	blue	spring	Culinary uses
<i>Rumex acetosa</i> (common sorrel)	60cm (24in)			Leaves used in sauces, soups
<i>Ruta graveolens</i> (common rue)	60cm (24in)	yellow	summer	Attractive blue-green foliage. Cultivated for medicinal use
<i>Salvia elegans</i> (pineapple sage)	60cm (24in)	blue, purple	summer	Sunny location, culinary
<i>Salvia officinalis</i> (common sage)	60cm (24in)	purple, pink or white	summer	Sunny location, culinary
<i>Salvia officinalis</i> 'Aurea'	60cm (24in)	golden edge foliage	summer	Sunny location, culinary and ornamental use
<i>Salvia officinalis</i> 'Berggarten'	60cm (24in)	purple	e. summer	Compact in habit
<i>Salvia officinalis</i> 'Purpurascens' (purple sage)	60cm (24in)	blue, purple	summer	Sunny location, culinary, decorative
<i>Salvia officinalis</i> 'Tricolor' (tri-colour sage)	60cm (24in)	purple	summer	Sunny location, culinary, decorative
<i>Satureja hortensis</i> (summer savory)	30cm (12in)	pale pink	summer	Sunny location, culinary
<i>Satureja ontana</i> (winter savory)	30cm (12in)	pale pink	summer	Sunny location, culinary
<i>Stevia rebaudiana</i> (stevia)	38cm (15in)		summer	Annual. Leaves are a natural sweetener
<i>Tagetes lucida</i> (Spanish tarragon)	20cm (8in)	yellow	summer	Culinary, medicinal. Leaves have a tarragon-like flavour
<i>Thymus</i> 'Spicy Orange' (orange-scented thyme)	8cm (3in)	pink	e. summer	Will tolerate moderate foot traffic
<i>Thymus x citriodorus</i> 'Archer's Gold' (lem. thyme)	15cm (6in)	purple w. golden foliage	summer	Culinary, hardy
<i>Thymus x citriodorus</i> 'Aureus' (gold lemon thyme)	15cm (6in)	purple	summer	Gold-splashed leaves
<i>Thymus citriodorus</i> 'Doone Valley'	groundcover	purple	summer	Variegated foliage, lemon scented
<i>Thymus x citriodorus</i> 'Silver Queen'	groundcover	purple	summer	Variegated foliage. Looks good as a front of border plant
<i>Thymus praecox</i> 'Coccineus' (red creeping thyme)	groundcover	magenta-red	summer	Good, mat-forming perennial
<i>Thymus pseudolanuginosus</i> (woolly thyme)	groundcover	pale pink	summer	Soft, grey-green woolly leaves

HERBS

Plant Name	Height	Colour	Bloom	Information
<i>Thymus serpyllum</i> 'Elfin' (mother of thyme)	5cms (2in)	magenta-pink	summer	Diminutive, glossy leaves, hummock-forming habit
<i>Thymus serpyllum</i> 'Pink Chintz'	groundcover	salmon-pink	summer	Vigorous cultivar
<i>Thymus vulgaris</i> (English winter thyme)	groundcover	purple or white	summer	Best culinary use. Well drained, sunny position
<i>Thymus vulgaris</i> 'Italian Oregano' (oregano thyme)	30cm (12in)	pink	summer	Culinary, hardy
<i>Thymus vulgaris</i> 'Narrow Leaf French'	30cm (12in)	pink	summer	Excellent culinary cultivar
<i>Valeriana officinalis</i> (valerian)	150cms (60in)	pink/white	summer	Medicinal. Sweetly scented flowers

TOMATOES

F1 Hybrid Types	Information
Beefsteak type	Best all round beefsteak from Stokes. Big and juicy
Chiquita	Sweet pink olive type, very good producer
Gold Nugget	Golden cherry. Very sweet. Good for hangers
Moneymaker	Long standing. Good producer, average size, old fashioned taste
New Girl	Improved. Replaces Early Girl. Good all round size and flavour
Orange Blossom	Sweet orange, 4 to 6 oz. tomatoes
Sungold	Awesome golden golf balls. A must grow, very, very sweet
Sweet Million	Sweet cherry type that produces tons! Replaces Sweet 100
Sweet Olive	Developed for greenhouse T O V (tomato on the vine). Olive shape, sweet and juicy. Does well in gardens
Suncherry	The sweetest-tasting, shiny red-skinned cherry variety available
Taxi	Sweet average size yellow, low acid
Tumbler	Brian Minter's favourite, a "no brainer". Always produces red golf balls. Excellent in hangers
Heirloom Tomato Varieties – 40 days is classed as early	
Black Prince; Cherokee Purple; Eva's Purple Ball; Green Zebra; Japanese Black Trifele; Moskvich (early); Nepal (early);	
Red Brandywine; Striped German; Valencia; Yellow Brandywine	

Some of the list will be available. Selections of Tomato and Vegetable varieties are dependent on our early spring weather. Protect your tomato plants until late May.

VEGETABLES

Mothers Day herb planters – will contain a selection of the following herbs; Bay, Thyme, Rosemary, Winter savory, Sage, Oregano, Parsley, or Chives
Soup Pot herb combinations – Bay, Thyme, Lovage, Rosemary, Winter savory, Sage, Oregano, Parsley
Salad garden mixed planter – assortment of greens eg Lettuce, Mesclun greens, Mustard, Chives, Rocket, Shallots, purple and green Basil
Vegetables that may be available include; Celery, Cabbage, Egg plant (small size), Kale, Leeks, Peppers, Rainbow Chard, Radicchio, Rhubarb, Spinach

MUSHROOMS KITS

Mushroom Name	Information
Oyster (king, pink, golden, white)	Fit the concept of designer mushroom, since they come in a wide variety of colours, shapes and sizes
Shitake (Black Forest or Chinese mushroom)	Next to Button, Shitake is the most cultivated mushroom in the world. Used in many Asian dishes

SEEDS

Plant Name	Description
Red & White	In honour of Canada's 150th birthday, we are featuring seeds of plants with colours of red or white in either their flowers, fruit or leaves.
Trees and Shrubs:	
<i>Calycanthus occidentalis</i>	California Allspice is a large shrub with aromatic dark green leaves and red flowers that look like tiny water lilies.
<i>Cornus nuttallii</i>	The Pacific dogwood bears white flowers (bracts) in spring, orange-red fruit in fall with beautiful, fall foliage colour
<i>Euonymus alatus</i>	The leaves of the burning bush turn bright scarlet in autumn.
<i>Meliosma pinnata</i> var. <i>oldhamii</i>	This small tree has feathery foliage and bears panicles of white flowers in early summer.
<i>Ribes sanguineum</i>	The flowering currant is a Western North American native that was a favourite in Victorian temperate gardens and is slowly being rediscovered for its simple elegance
<i>Rosa highdownensis</i>	This species rose bears single red flowers, followed by large, flask-shaped red hips.
Perennials:	
<i>Aquilegia formosa</i>	This columbine has deeply divided leaflets and bears pendent flowers with orange sepals, yellow petals with red lobes and reddish-orange spurs. A western North America native plant
<i>Asclepias incarnata</i>	This milkweed loves wet soil and bears clusters of rose-red flowers attractive to bees and butterflies.
<i>Cornus canadensis</i>	Bunchberry is a lovely woodland groundcover that bears white dogwood-like flowers (actually bracts) that are followed by bright red, spherical fruits
<i>Crocsmia</i> 'Lucifer'	This montbretia bears bright red flowers in arching spikes on wiry stems in midsummer
<i>Epilobium canum</i>	In summer, California Fuchsia produces tubular scarlet flowers that attract hummingbirds.
<i>Iris sibirica</i> 'Alba'	This Siberian iris bears white flowers from mid-spring to early summer.
<i>Lobelia tupa</i>	Devil's Tobacco is a large perennial that bears spikes of tubular flowers loved by hummingbirds.
<i>Ornithogalum candicans</i>	Summer hyacinth has tubular white fragrant flowers above lance-shaped gray-green leaves in summer
Annuals	
<i>Amaranthus hypochondriasis</i> 'Purpurea'	Purple Prince's Feather has purple leaves and produces small crimson flowers in summer. Good cut or dried flower
<i>Cleome hassleriana</i> 'Alba'	White spider flower is a tall annual bearing white, spidery flowers in summer
<i>Nicotinia glauca</i>	Ornamental tobacco is another tall annual that bears white flowers: the blooms are evening scented. Good cut flower
<i>Papaver somniferum</i> 'Red'	This poppy has large red flowers above gray-green leaves that are followed by attractive seed pods. Good for drying.

The Seed Collectors offer many more seeds of trees, shrubs, annuals, perennials at the plant sale and online at www.vandusen.org - click on Seed Sales.

The flower of the western trillium, Trillium ovatum, is like three flowers in one: it opens pure white, then fades to pink and finally turns dark purple before going to seed. The seeds are spread by ants that feed on a fleshy part of the seed structure. Trilliums naturally go dormant and die to the ground during our dry summers, like so many early spring-flowering native species. They do come up the following year, sometimes in new, unexpected places thanks to the ants.

PERENNIALS

Plant Name	Height	Colour	Bloom	Expos.	Fragr.	Description
<i>Actaea ramosa</i> 'Pink Spire' (bugbane)	90cm (36in)	pale pink	summer	☼●●	yes	Bottle-brush type flowers atop bronze-purple foliage
<i>Achillea sibirica</i> ssp. <i>camstchatica</i>	50cm (20in)	pink	June-Sept	☼		Variety 'Love Parade', glossy fern-like leaves. Butterflies
<i>Adiantum venustum</i>	15cm (6in)	fern	evergreen	○		Delicate, but hardy maidenhair fern. Woodland plantings
<i>Agastache</i> 'Blue Fortune'	60cm (24in)	violet-blue	summer	☼○		Upright, long bloomer, attracts hummingbirds
<i>Ajuga reptans</i> 'Black Scallop'	10cm (4in)	blue	e. spring	☼○		Ground cover, dark foliage, spikes of bright blue flowers
<i>Allium karataviense</i>	25cm (10in)	white	spring	☼		Fabulous, blue-green leaves, opens to white globe flower
<i>Anemone nemorosa</i>	10cm (4in)	white/pink	e. spring	☼○		Summer dormant, woodland groundcover; plant with hosta
<i>Anemone nemorosa</i> Blue form	10cm (4in)	blue	e. spring	☼○		Summer dormant, woodland groundcover
<i>Anemone nemorosa</i> 'Bracteata'	10cm (4in)	white/green	e. spring	○		Unusual double form, not a fast spreader
<i>Anemone nemorosa plena</i>	10cm (4in)	white	e. spring	☼○		Double form, not a fast spreader
<i>Anemone x hybrida</i> 'Cinderella'	45cm (18in)	pink	summer	☼○		Compact, upright, flowers mid-summer to fall
<i>Aquilegia</i> 'Woodside Gold' (columbine)	50cm (20in)	purple	late spring	☼○		Chartreuse foliage, brightens shady area
<i>Aquilegia vulgaris</i> 'Blue Barlow'	60cm (24in)	blue	late spring	☼		Exquisite, fully double deep violet-blue
<i>Aralia cachemirica</i>	to 3 metres	white	summer	☼○		Gorgeous foliage, purple-black berries in fall
<i>Aralia cordata</i> 'Sun King'	75cm (30in)	white	l. summer	●●		Bright gold foliage remains throughout the season
<i>Arisaema concinnum</i> (Japanese cobra lily)	100cm (40in)	foliage	summer	●●		Impressive plant with a single, large leaf
<i>Arisaema consanguineum</i> (cobra lily)	90cm (36in)	foliage	summer	○		Unusual hooded flower; summer bulb for woodland garden
<i>Arisaema galeatum</i>	90cm (36in)	foliage	summer	●●		Helmeted cobra lily. Rare species from north India
<i>Arisaema griffithii</i>	60cm (24in)	foliage	summer	●●		Heavily lined and veined
<i>Arisaema sikokianum</i> (Japanese cobra lily)	30cm (12in)	foliage	summer	●●		Dark brown "pulpit" and a snow white "jack"
<i>Arisaema speciosum</i>	75cm (30in)	foliage	summer	●●		Himalayan giant cobra lily; heavily-textured leaflets
<i>Arisarum proboscideum</i> (mouse plant)	10cm (4in)	brown	spring	○		Glossy leaves, mouse-tail-shaped flower
<i>Artemisia</i> 'Silver Mound'	30cm (12in)	cream	summer	☼○		Soft mounding foliage
<i>Arum italicum</i> 'Pictum'	25cm (10in)	foliage	fall	☼○		Summer dormant
<i>Asarum caudatum</i>	25cm (10in)	foliage	evergreen	●●		Lush green, shiny, heart-shaped foliage
<i>Asclepias incarnata</i> 'Soulmate' (milkweed)	90cm (36in)	deep pink	summer	☼	yes	Butterfly favourite and interesting seed pods
<i>Asclepias incarnata</i> 'Cinderella' (milkweed)	100cm (40in)	rose pink	summer	☼		Deadheading will stimulate another bloom cycle
<i>Aster divaricatus</i>	60cm (24in)	white	summer	●●		Tolerates dry conditions; attractive to butterflies
<i>Aster x frikartii</i> 'Monch'	60cm (24in)	lavender-blue	fall	☼○		Known for vigour, mildew resistance, long flowering time
<i>Astilbe x arendsii</i> 'Burgundy Red'	50cm (20in)	raspberry-red	e-summer	☼○		Glossy, deep green, finely-dissected leaves
<i>Astilbe chinensis</i> 'Vision in White'	60cm (24in)	white	summer	●●		Snowy-white plumes provide excellent contrast
<i>Astilbe japonica</i> 'Peach Blossom'	45cm (18in)	peach	summer	○		Attracts butterflies. Long season of bloom
<i>Astilbe simplicifolia</i> 'Moulin Rouge'	15cm (6in)	dark pink	summer	●●		Compact, with dark foliage
<i>Astilbe x thunbergii</i> 'Charm'	90cm (36in)	red	summer	○		Good for mass planting in shady sites
<i>Astilbe</i> 'Younique Silvery Pink'	50cm (20in)	pale pink	summer	●●	yes	Low mound of lacy-green foliage. Cut flowers
<i>Astrantia major</i> 'Roma'	70cm(28in)	pink	summer	☼		Long lasting flowers, great for cutting
<i>Aubrieta</i> 'Axcnt Purple' (purple rock cress)	15cm (6in)	mauve	late spring	☼○		Ideal for front of borders, rock gardens, attracts butterflies
<i>Athrium</i> 'Branford Beauty'	50cm (20in)	fern		●●		Cross between lady fern and Japanese painted fern

PERENNIALS

Plant Name	Height	Colour	Bloom	Expos.	Fragr.	Description
<i>Athrium</i> 'Ghost'	50cm (20in)	fern		●●		Stunning frosted apple-green fronds
<i>Athrium nipponicum</i> 'Red Beauty'	50cm (20in)	fern		●●		Relative of Japanese painted fern, dark burgundy veins
<i>Bergenia ciliata</i>	30cm (12in)	pink	summer	☼●		Large fuzzy leaves; deciduous, emerges in spring; bees
<i>Bletilla striata</i> 'Sorya Blue Dragon'	60cm (24in)	violet	summer	○		Best grown in moist soil, thrives in containers
<i>Boehmeria tricuspidis</i> (grass turtle tail)	80cm (32in)	burgundy	late sum	☼●		Ornamental leaves, dark red stems, long tails of flowers
<i>Camassia leichtlinii</i> subsp. <i>suksdorfii</i>	60cm (24in)	blue	late spring	☼●		Spring-flowering native perennial
<i>Camassia quamash</i> (common camas)	30cm (12in)	blue	late spring	☼●		Naturalizes well in gardens
<i>Campanula</i> 'Bernice'	60cm (24in)	blue/purple	m. summer	☼●		Forms a low clump, with upright spikes of double flowers
<i>Campanula carpatica</i> 'White Clips'	15cm (6in)	white	e. summer	☼●		Clear white flowers, blooms for weeks with trimming
<i>Cardamine heptaphylla</i>	60cm (24in)	pink	April-May	○		Flowers above clusters of much-divided, umbrella leaves
<i>Cardiocrinum giganteum</i> (giant Himalayan lily)	3m (10ft)	white	summer	○	yes	The largest species of all lily plants; spectacular in flower
<i>Chasmanthium latifolium</i> (northern sea oats)	90cm (36in)	grass	l. summer	☼		Clump-forming, upright ornamental grass
<i>Chelone oblique</i> 'Alba' (turtlehead)	60cm (24in)	white	l. summer	☼●		Bears upright stems of hooded flowers; showy, long-lived
<i>Clematis recta</i> 'Purpurea'	100cm (40in)	purple	summer	☼●	yes	Purple spring foliage, sprawling, bushy habit, hardy
<i>Convallaria majalis</i> 'Albostriata'	15cm (6in)	white	late spring		yes	Golden-striped foliage, slowly spreading 'lily-of-the-valley'
<i>Convallaria majalis</i> var. <i>rosea</i> (lily-of-the-valley)	15cm (6in)	pink	late spring	○	yes	Good ground cover in woodland setting
<i>Coreopsis verticillata</i> 'Grandiflora'	60cm (24in)	yellow	summer	☼		Prompt deadheading encourages additional blooms
<i>Coreopsis verticillata</i> 'Zagreb'	35cm (14in)	golden-yellow	summer	☼		Blooms from early through late summer
<i>Corydalis solida</i> 'G. P. Baker'	10cm (4in)	red & white	April-May	○		Blue-green, fern-like foliage. Summer dormant
<i>Delphinium</i> NZ 'Blue Lace'	150cm (5ft)	blue	summer	☼		Tall stately spikes
<i>Delphinium</i> Pacific Giant 'Black Knight'	150cm (5ft)	dark violet	summer	☼		Tall stately spikes
<i>Deinanthoe caerulea</i> (false hydrangea)	50cm (20in)	blue-violet	summer	●●		Does well in cool, moist, shady woodland area
<i>Dianthus cruentis</i>	50cm (20in)	red	summer	☼		Brilliant flowers; grassy e/g foliage. Butterflies and bees
<i>Dianthus isensis</i> 'Dancing Geisha'	20cm (8in)	pink to purple	April-Aug	☼		Very fringed flowers shades of pink, red, white, purple
<i>Dicentra spectabilis</i> (bleeding heart)	70cm (28in)	pink	late spring	○		Dangling bright-pink "locket" flowers. Ferny foliage
<i>Dicentra spectabilis</i> 'Alba' (bleeding heart)	100cm (40in)	white	spring	○		White form of bleeding heart
<i>Dicentra spectabilis</i> 'Goldheart' (bleeding heart)	70cm (28in)	pink	summer	☼●		Golden yellow foliage
<i>Dicentra spectabilis</i> 'Valentine'	60cm (24in)	scarlet	spring	○		Plum-green foliage with red stems and flowers
<i>Digitalis grandiflora</i> (yellow foxglove)	60cm (24in)	yellow	summer	☼		Narrow, dainty flowers, attracts bees and butterflies
<i>Echinacea purpurea</i> 'Harvest Moon'	75cm (30in)	golden	summer	☼	yes	Strong branching stems, wide petals, profuse blooming
<i>Echinacea purpurea</i> 'Magnus'	75cm (30in)	deep pink	summer	☼		Classic purple coneflower. Deadhead for long bloom
<i>Echinacea purpurea</i> 'Pow Wow Wild Berry'	75cm (30in)	rose-purple	summer	☼		Cheerful flowers. Seed heads provide winter food for birds
<i>Epimedium grandiflorum</i> 'Purple Pixie'	25cm (10in)	purple	spring	☼●		Drought tolerant, perfect for use as groundcovers
<i>Epimedium pubigerum</i> 'Orange Queen'	45cm (18in)	orange	spring	☼●		Delicate shade plants, perfect for use as groundcovers
<i>Epimedium</i> x <i>versicolour</i> 'Sulphureum'	20cm (8in)	yellow	spring	●●		Bronze tinged foliage in spring turns more intense in fall
<i>Eremurus isabellinus</i> 'Cleopatra' (fox tail lily)	90cm (36in)	peach	summer	☼		Strong, upright spikes
<i>Eryngium bourgatii</i>	45cm (18in)	blue	summer			Deeply-lobed, silver-veined leaves, well drained soil
<i>Erysimum</i> 'Winter Joy' (shrubby wallflower)	60cm (24in)	purple	summer			Compact. Blooms for months

PERENNIALS

Plant Name	Height	Colour	Bloom	Expos.	Fragr.	Description
<i>Euphorbia x martini</i> 'Tiny Tim'	25cm (10in)	cream/green	summer	☼		Compact form; cream flowers on green foliage
<i>Eurybia divaricata</i>	30cm (12in)	white	l. summer	●●		Clouds of white flowers on black stems. Drought tolerant
<i>Fibigia clypeata</i>	50cm (20in)	yellow	summer	☼		Grey fuzzy leaves, yellow flwrs followed by velvety pods
<i>Filipendula</i> 'Kahome'	50cm (20in)	rose	summer	☼○		Deer proof, prefers continuously moist soil
<i>Gaura lindheimeri</i> 'Snow Fountain'	75cm (30in)	white	summer	☼		Dense, upright red stems, drought tolerant
<i>Gentiana asclepiadea</i> (willow gentian)	45cm (18in)	rich blue	summer	☼		Rich blue flwrs, graceful, arching stems. Rich, moist soil
<i>Gentiana septemfida</i> var <i>lagodechiana</i>	15cm (6in)	blue	summer	☼○		Highly treasured for rich flower display in summer
<i>Geranium</i> 'Tiny Monster'	40cm (16in)	magenta	summer	☼○		Reliable performer, spreads quickly
<i>Geranium phaeum</i> 'Samobor'	60cm (24in)	maroon	summer	☼○		Bold, purple-black splash on leaves. Good texture and form
<i>Geranium pratense</i> 'Hocus Pocus'	25cm (10in)	lavender	sum/fall	☼○		Dark foliage, mounding growth habit
<i>Geranium pratense</i> 'Victor Reiter'	50cm (20in)	blue	summer	☼		Stunning display of foliage. Trim back after flowering
<i>Hacquetia epipactus</i>	10cm (4in)	yellow	e. spring	●●		Unusual, striking flowers, chartreuse leaves. Moist soil
<i>Helenium</i> 'Double Trouble' (sneezeweed)	80cm (32in)	yellow	summer	☼		Fluffy, double petals surround a golden eye
<i>Helenium</i> 'Kanaria'	90cm (36in)	yellow	summer	☼		Blooms mid to late summer. Attracts butterflies
<i>Helenium</i> 'Sahin's Early'	90cm (36in)	orange	summer	☼		Long flowering season
<i>Helianthus</i> 'Lemon Queen'	175cm (72in)	yellow	sum/fall	☼○		Tough, reliable plant, prolific flowers are long lasting
<i>Helleborus</i> 'Anna's Red'	45cm (18in)	purple-red	e. spring	●●		Incredibly unique foliage & stunning bouquet of purple-red
<i>Helleborus</i> 'Pippa's Purple'	30cm (12in)	violet-purple	l. winter	●●		Stunning silver-veined foliage
<i>Helleborus argutifolius</i>	90cm (36in)	green	e. spring	☼		Best used as a specimen plant
<i>Helleborus orientalis</i> hybrids (Lenten rose)	60cm (24in)	white	e. spring	○		Shades of white or pink
<i>Hemerocallis</i> 'Canadian Border Patrol'	70cm (28in)	cream/purple	summer	☼○		Creamy-yellow with a deep purple eye. Repeat bloomer
<i>Hemerocallis</i> 'Fragrant Returns'	45cm (18in)	lemon-yellow	e. summer	☼○	yes	Light lemon-yellow, 4" ruffled flowers. Extended bloom
<i>Hemerocallis</i> 'Here Lies Butch'	50cm (20in)	cream/purple	summer	☼○		Thick creamy petals with purple & lime trim. Stunning
<i>Hemerocallis</i> 'Kwanso'	90cm (36in)	orange	summer	☼○		Showy fully double, will naturalize
<i>Hemerocallis</i> 'Longfield's Ice Cup'	45cm (18in)	wh/chartreuse	summer	☼○		Elegant white trumpets, chartreuse centre and green throat
<i>Hemerocallis</i> 'Snaggle Tooth'	80cm (32in)	deep pink	summer	☼○		Rich, deep, pink-coloured double petals edged with white
<i>Hemerocallis</i> 'Tetrina's Daughter'	60cm (24in)	yellow	summer	☼○	yes	15cm (6in) bloom, spider type flowers, very prolific
<i>Hosta</i> hybrid 'Barbara Ann'	50cm (20in)	white	summer	●●		Good texture and form
<i>Hosta</i> hybrid 'Blue Mouse Ears'	20cm (8in)	lavender	summer	●●		Adorable miniature hosta
<i>Hosta</i> hybrid 'Brother Stephen'	50cm (20in)	white	summer	●●		Thick, heavily-corrugated, puckered gr. leaves, gold centre
<i>Hosta</i> hybrid 'Carnival'	45cm (18in)	lavender	summer	●●		Wavy cream edge, sport of 'Great Expectation'
<i>Hosta</i> hybrid 'Elegans'	50cm (20in)	white	summer	●●		Slug resistant, blue-green leaves
<i>Hosta</i> hybrid 'El Nino'	50cm (20in)	lavender	summer	●●		Chalky-blue colour with white edge
<i>Hosta</i> hybrid 'Fire and Ice'	40cm (16in)	lavender	summer	●●		Variiegated, with slightly twisted foliage
<i>Hosta</i> hybrid 'First Frost'	40cm (16in)	lavender	summer	●●		Emerges with gold margin early spring & changes to white
<i>Hosta</i> hybrid 'Fragrant Bouquet'	90cm (36in)	white	summer	●●	yes	Apple green leaves, with wide cream margins
<i>Hosta</i> hybrid 'Frosted Mouse Ears'	20cm (8in)	lavender	summer	☼○		Dwarf, great for containers
<i>Hosta</i> hybrid 'Golden Tiara'	40cm (16in)	purple shades	summer	●●		Fast clumping habit, excellent for edging

PERENNIALS

Plant Name	Height	Colour	Bloom	Expos.	Fragr.	Description
<i>Hosta</i> hybrid 'Holy Mouse Ears'	15cm (6in)	lavender	summer	●●		Beautiful mound of cream-centred leaves
<i>Hosta</i> hybrid 'Independence'	55cm (22in)	p. lavender	summer	●●		Dark green, wide, creamy margins speckled with green
<i>Hosta</i> hybrid 'Komodo Dragon'	75cm (30in)	lavender	summer	☼○		Large, blue quilted foliage
<i>Hosta</i> hybrid 'Krossa Regal'	70cm (28in)	purple shades	summer	●●		Graceful, vase-like habit. Slug resistant
<i>Hosta</i> hybrid 'Lakeside Cupcake'	12cm (5in)	lavender	summer	☼○		Dwarf, thick foliage
<i>Hosta</i> hybrid 'Lakeside Paisley Print'	25cm (10in)	lavender	summer	☼○		Unique leaves with quilted foliage
<i>Hosta</i> hybrid 'Little Treasure'	20cm (8in)	lavender	summer	☼○		Miniature, great for containers
<i>Hosta</i> hybrid 'Loyalist'	45cm (18in)	lavender	summer	☼○		Sport of 'Patriot'
<i>Hosta</i> hybrid 'Lucky Mouse'	20cm (8in)	lavender	summer	☼○		Miniature, great for containers
<i>Hosta</i> hybrid 'Orange Marmalade'	45cm (18in)	p. lavender	summer	●●		Slightly quilted, yellow centre with a hint of orange
<i>Hosta</i> hybrid 'Patriot'	60cm (24in)	lavender	summer	☼○		Hosta of the Year 1997
<i>Hosta</i> hybrid 'Pizzazz'	50cm (20in)	white	summer	☼○		Thick corrugated leaves
<i>Hosta</i> hybrid 'Praying Hands'	30cm (12in)	lavender	summer	☼○		Hosta of the Year 2011; very upright habit
<i>Hosta</i> hybrid 'Rainforest Sunrise'	20cm (8in)	purple shades	summer	●●		Emerges l. green, develops dk. gr. border and gold centres
<i>Hosta</i> hybrid 'Rootin Tootin'	25cm (10in)	lavender	summer	☼○		Cupped, quilted green leaves with cream centre
<i>Hosta</i> hybrid 'Snake Eyes'	50cm (20in)	p. lavender	summer	●●		Unique leaf colouration for shade garden
<i>Hosta</i> hybrid 'Striptease'	50cm (20in)	purple shades	summer	●●		Pointy, ovate, dark green leaves, with narrow gold centres
<i>Hosta</i> hybrid 'Sun Power'	75cm (30in)	lavender	summer	☼○		Sun tolerant, wavy edge
<i>Hosta</i> hybrid 'Valley's Glacier'	100cm (40in)	lavender	summer	☼○		Blue heart shaped leaves with cream margin
<i>Hosta</i> (<i>Tardiana</i> group) 'Halcyon'	50cm (20in)	lilac/blue	summer	●●		Blue-green foliage. Attracts hummingbirds
<i>Iris aucheri</i>	40cm (16in)	white	June	☼	yes	Early show of foliage. Flowers have a violet-like scent
<i>Iris chrysographes</i> 'Black Knight'	45cm (18in)	black	May	☼○		Stunning velvety-gold black flowers; fertile, moist soil
<i>Iris chrysographes</i> 'Rubella'	60cm (24in)	purple-violet	June	☼○		Commonly-known as the 'black iris'. Easily grown
<i>Iris ensata</i> 'Frosted Pyramid' (Japanese Iris)	90cm (36in)	white	summer	☼○		Prefers moist soil, late blooming
<i>Iris hollandica</i> 'Sapphire Beauty' (Dutch Iris)	60cm (24in)	blue	June	☼		Good for bouquets
<i>Iris magnifica</i>	60cm (24in)	lilac	June	☼		Rare and vigorous beauty, both in flower and foliage
<i>Iris pallida</i> 'Aureovariegata'	55cm (22in)	blue	June	☼		Creamy variegated foliage
<i>Iris robusta</i> 'Gerald Darby'	80cm (32in)	violet blue	June	☼		Unique emerging purple foliage
<i>Iris sibirica</i> 'Butter and Sugar'	60cm (24in)	white/yellow	June	☼		Excellent flower form; possible rebloom later in summer
<i>Iris sibirica</i> 'Coronation Anthem'	75cm (30in)	blue	June	☼		Blooms profusely, re-blooms in fall, large ruffled petals
<i>Iris sibirica</i> 'Pink Parfait'	100cm(40in)	pink-lavender	June	☼		Stunning double, pink-lavender blooms. Looks like a rose
<i>Iris unguicularis</i> 'Mary Barnard'	40cm (16in)	violet blue	Jan.- Mar.	☼		Superb dark-flowered form of this winter-blooming iris
<i>Ixiolirion tataricum</i> (mountain lily)	40cm (16in)	blue	spring	☼		Sheltered sunny spot or patio pot for a splash of colour
<i>Lavendula angustifolia</i> 'Hidcote Blue'	45cm (18in)	purple	summer	☼	yes	Requires good drainage
<i>Leucanthemum x superbum</i> 'Banana Cream'	60cm (24in)	lemon-yellow	summer	☼		Flwrs mature to cream, long blooming, sturdy. Cut flowers
<i>Leucanthemum x superbum</i> 'Goldfinch'	60cm (24in)	bright yellow	summer	☼		Semi-double, fade to ivory. Compact, bushy. Butterflies
<i>Leucanthemum x superbum</i> 'Real Galaxy'	40cm (16in)	white	summer	☼		Layers of petals surrounded by a large centre
<i>Leucanthemum x superbum</i> 'Lacrosse'	30cm (12in)	white	summer	☼		Interesting spoon-shaped petals and raised 'egg-yolk' centres

PERENNIALS

Plant Name	Height	Colour	Bloom	Expos.	Fragr.	Description
<i>Lewisia longipetala</i> 'Little Mango'	15cm (6in)	mango-colour	May-June	☼		Evergreen rosette, needs excellent drainage. Butterflies
<i>Ligularia przewalskii</i>	150cm(60in)	yellow	summer	☼○		Toothed foliage, best in moist soil
<i>Lilium martagon</i> (Turk's cap lily)	70cm (28in)	pink	summer	☼○	yes	Reflexed flowers, attracts hummingbirds
<i>Lilium</i> OA Hybrid 'Kaveri'	90cm (36in)	yellow & red	summer	☼○	yes	Vibrant, large, long-lasting flowers
<i>Lilium</i> Oriental 'Chill Out' (oriental lily)	100cm (40in)	yellow/white	summer	☼○	yes	Tall-growing, produces 3-5 flowers per stem
<i>Lilium</i> Oriental 'Extravaganza' (oriental lily)	100cm (40in)	white	summer	☼○	yes	Pink freckles, huge blooms
<i>Lilium</i> Oriental 'Mona Lisa'	100cm (40in)	rose pink	summer	☼○	yes	Double white oriental
<i>Lilium</i> Oriental 'Roselily Annika'	90cm (36in)	white	summer	☼○	yes	Double fragrant oriental lily, ideal for cutting
<i>Lilium</i> Oriental 'Sunny Bonaire'	50cm (20in)	pink	summer	☼○	yes	This compact selection has ruffled petals
<i>Lilium</i> Oriental 'Sunny Keys'	45cm (18in)	red,pink,white	summer	☼○	yes	Bold colours, fragrant, long-blooming. Hummingbirds
<i>Lilium</i> OT Hybrid 'Montego Bay'	100cm (40in)	yellow & red	summer	☼	yes	Pink and peach with contrasting yellow centre
<i>Lilium</i> OT Hybrid 'Table Dance'	100cm (40in)	pink	summer	☼	yes	Showy pink flowers with white centres. Hummingbirds
<i>Lilium</i> Trumpet 'African Queen'	120cm(48in)	orange	summer	☼○	yes	Most lilies prefer rich, organic soil and full sun
<i>Lilium</i> Trumpet 'Pink Perfection'	100cm (40in)	pink	summer	☼○	yes	More drought-tolerant than many other types of lilies
<i>Lobelia</i> 'Queen Victoria'	90cm (36in)	red	summer	☼		Dark burgundy foliage. Hummingbirds love these flowers
<i>Lupinus</i> 'Woodfield Hybrids' (lupin)	90cm (36in)	mixed	summer	☼		Deadhead to promote re-bloom
<i>Meconopsis betonicifolia</i> (Himalayan poppy)	60cm (24in)	deep blue	June-July	○		Requires woodland conditions, moist soil in summer
<i>Meconopsis grandis</i> (Himalayan poppy)	60cm (24in)	deep blue	June-July	○		Requires woodland conditions, moist soil in summer
<i>Miscanthus sinensis</i> 'Harrison Yellow'	200cm(80in)	grass	Oct-Nov	☼		Strong stems, yellow, green striped foliage, white midrib
<i>Miscanthus sinensis</i> 'Little Kitten'	90cm (36in)	grass	l.summer	☼		Produces a lush foliage clump. Great single specimen
<i>Monarda</i> 'Blue Stocking' (bee balm)	80cm (32in)	violet-blue	summer	☼	yes	A unique colour for monarda. Good drought tolerance
<i>Monarda</i> 'Jacob Kline' (bee balm)	90cm (36in)	red	summer	☼	yes	Mildew resistant, deep red
<i>Nepeta racemosa</i> 'Walker's Low' (cat nip)	35cm (14in)	blue	summer	☼	yes	Rich blue flowers, good in rock gardens
<i>Ophiopogon planiscapus</i> 'Nigrescens' (mondo)	20cm (8in)	violet	summer	☼●●		Dwarf, compact, mondo grass with black leaves
<i>Oxalis adenophylla</i> (silver shamrock)	10cm (4in)	pink	summer	☼○		Excellent ground cover, cold hardy
<i>Pachyphragma macrophyllum</i>	35cm (14in)	white	spring	☼○		Rounded, ruffled leaves form a weed-free ground cover
<i>Paeonia</i> Itoh 'Bartzella'	65cm (25in)	yellow	l. spring	☼	yes	Huge, semi double flowers, with lemony fragrance
<i>Paeonia</i> Itoh 'Callie's Memory'	90cm (36in)	creamy/purple	June-July	☼	yes	Herbaceous tree peony cross, 22cm (9in) blooms
<i>Paeonia</i> Itoh 'Canary Brilliants'	70cm (28in)	yellow	June	☼	yes	Vibrant, canary-yellow blooms for intense garden colour
<i>Paeonia</i> Itoh 'Cora Louise'	60cm (24in)	pink	June-July	☼	yes	Fragrant, can produce up to 50 blooms per season
<i>Paeonia</i> Itoh 'Julia Rose'	100cm (40in)	pink	June-July	☼	yes	Double form, unique
<i>Paeonia lactiflora</i> 'Athens'	70cm (28in)	bright pink	e.summer	☼		Patio series suitable for containers. Semi-double
<i>Paeonia lactiflora</i> 'Dublin'	60cm (24in)	white	spring	☼		Large single white flowers, with yellow centre
<i>Paeonia lactiflora</i> 'Kiev'	50cm (20in)	dark pink	spring	☼		Single, dark pink flowers, with yellow centre
<i>Paeonia lactiflora</i> 'London'	50cm (20in)	raspberry-pink	spring	☼		Fully-double, frilly, raspberry-pink. Compact growth
<i>Paeonia lactiflora</i> 'Madrid'	50cm (20in)	white/cream	spring	☼		Perfect size for a container. Semi-double
<i>Paeonia lactiflora</i> 'Moscow'	60cm (24in)	red/yellow eye	spring	☼		Russet-red flowers with yellow eye. Semi double
<i>Papaver orientale</i> 'Beauty of Livermere'	75cm (30in)	scarlet	June-July	☼		Bright scarlet Oriental poppy with purple centre

PERENNIALS

Plant Name	Height	Colour	Bloom	Expos.	Fragr.	Description
<i>Papaver orientale</i> 'Snowgoose'	50cm (20in)	cream/purple	June-July	☼		Large, frilled semi-double with purple-pink blotches
<i>Persicaria affinis</i> 'Dimity'	18cm (7in)	pink shades	summer	☼○		Red spikes changing to pink, great ground cover
<i>Peucedanum verticillare</i>	175cm (72in)	purple	July-Aug	☼		Ruby stems, purple leaves, great umbels of flowers. Biennial
<i>Phlomis cashmeriana</i>	50cm (20in)	lavender	summer	☼		Whorls of flowers, velvety leaves. Attracts hummingbirds
<i>Phlox paniculata</i> 'Laura'	100cm (40in)	purple/white	summer	☼		Remove faded flowers to encourage a second bloom
<i>Phlox paniculata</i> 'Purple Kiss'	35cm (14in)	purple	summer	☼○		Dwarf habit makes this suitable for the front of the border
<i>Phlox paniculata</i> 'Red Flame'	40cm (16in)	red	summer	☼	yes	Intense red-flowering dwarf cultivar. Disease resistance
<i>Phytolacca acinosa</i>	120cm(48in)	pink	summer	☼		Clusters of shiny purple berries follow flws. Loved by birds
<i>Platycodon grandiflora</i> 'Sentimental Blue'	18cm (7in)	blue	summer	☼○		Bloom grow like a balloon then pops open
<i>Podophyllum hexandrum</i> (mayapple)	50cm (20in)	soft pink	April-May	○		Large, glossy leaves. Woodlander
<i>Polygonatum x hybridum</i> 'Striatum'	60cm (24in)	white	June-Sep	☼○		Variegated foliage
<i>Polygonatum odoratum</i> 'Grace Barker'	25cm (10in)	white	June-Sep	○	yes	Dwarf, variegated variety; green leaves, edged white
<i>Polygonatum verticillatum</i> 'Rubrum'	150cm (60in)	pink	May-June	☼○		Dark new growth, very architectural form
<i>Primula elatior</i> (oxlip primrose)	30cm (12in)	pale yellow	spring	○	yes	Soft yellow, fragrant, trumpet flowers
<i>Primula polyneura</i>	30cm (12in)	rosy-red	May-July	○●		Thick scalloped leaves, woolly underside. Cool, moist shade
<i>Primula</i> 'Quaker's Bonnet'	10cm (4in)	mauve/lilac	spring	○		Double rose-like flowers. Moist shade
<i>Primula sieboldii</i> White form	10cm (4in)	white	spring	○		Delicate flwr, but tough, hardy plant. Hairy, scalloped leaf
<i>Primula</i> 'Sunshine Susie'	10cm (4in)	yellow	spring	○		Bright, double, buttercup-yellow flowers
<i>Primula vialii</i> (red hot poker primula)	30cm (12in)	red	spring	☼○		Emerges late, spike shaped flower
<i>Rodgersia pinnata</i> 'Chocolate Wings'	75cm (30in)	pink	summer	☼○		Prefers damp woodlands and by streams
<i>Rudbeckia fulgida</i> 'Goldsturm'	80cm (32in)	yellow	summer	☼		Easily adaptable coneflower
<i>Salvia nemorosa</i> 'Marcus'	20cm (8in)	blue-violet	summer	☼		Compact. Attracts butterflies and hummingbirds
<i>Saxifraga x arendsii</i> 'Merlot Red'	15cm (6in)	red	spring	☼○		Fernlike foliage grows low to ground in an evergreen mat
<i>Saxifraga x arendsii</i> 'Pink'	15cm (6in)	pink	spring	☼○		Fernlike foliage grows low to ground in an evergreen mat
<i>Saxifraga x geum</i>	20cm (8in)	white	summer	☼		Evergreen, spoon-shaped leaves with scalloped edges
<i>Saxifraga paniculata</i>	15cm (6in)	white	summer	☼		Low alpine plant forms small rosettes of evergreen leaves
<i>Scabiosa</i> 'Butterfly Blue'	35cm (14in)	blue	summer	☼		Pin-cushion flowers continue blooming into fall. Butterflies
<i>Sedum</i> 'Garnet Brocade'	50cm (20in)	purple	l. summer	☼		Low-growing, fleshy blue-green leaves
<i>Sedum spurium</i> 'Dragon's Blood'	35cm (14in)	pink	summer	☼		Excellent ground cover for hot, dry sites
<i>Stokesia laevis</i> (Stoke's aster)	50cm (20in)	lavender-blue	summer	☼		Nicely mounded foliage. Good cut flower
<i>Thalictrum</i> 'Elin' (meadow rue)	180cm (72in)	lavender	summer	☼○		Tallest meadow rue, but seldom needs staking
<i>Thalictrum delavayi</i> 'Hewitt's Double'	150cm (60in)	pink	summer	☼○		Sprays of double flowers
<i>Tradescantia andersoniana</i> 'Blue and Gold'	45cm (18in)	blue	summer	☼○		Chartreuse grassy leaves, rich gentian-blue flowers
<i>Trillium chloropetalum</i>	30cm (12in)	variable red/wh	spring	○		Red trillium, but colour is variable, sometimes white. Slow
<i>Triteleia peduncularis</i>	30cm (12in)	white&blue	l.spring	☼		Funnel-shaped flowers, white tinged with blue or purple
<i>Triteleia hyacinthina</i> (wild hyacinth)	30cm (12in)	white	l.spring	○	yes	Tight umbrels of upward-facing flowers. Good pollinator
<i>Veronica peduncularis</i> 'Georgia Blue'	20cm (8in)	blue	summer	☼		Ground cover, blooms summer till fall

The following symbols are used: Sun=☼ Part shade=○ Shade=●

PACIFIC NORTHWEST NATIVE PLANTS

Gardening with PNW Native Plants

- Plan according to the habitat conditions in which the plants naturally grow: sun exposure, slope (shedding or receiving water), soil moisture, soil nitrogen and soil texture - organic (add compost) to mineral (add sand and gravel)
- Plan for the mature size of the plant. Native plants are best when they can grow to a natural height and width without excessive pruning.
- Plant in descending layers. Many of our native plants are from forest habitats with multiple layers of trees that shade shrubs, perennials and ferns.
- Place plants together from the same habitats. They have evolved forms, leaf shapes and specific relationships to grow together successfully.
- Many perennials are spring-flowering when there is natural soil moisture available, and some go dormant in the summer.
- Plants in dry habitats usually prefer well-drained, low nitrogen soil; plants in very moist habitats usually prefer high nitrogen soil.
- Climate and habitats are changing; where possible use plants that prefer drier soils and that can survive dry summer conditions with watering restrictions.

Full Sun | Very Dry to Moderately Dry Soil or Summer-Dry Soil (SD)

Plant Name	Type Preferred Exposure	Max. Height	Flowers	Other Features
<i>Arbutus menziesii</i> (arbutus)	Broadleaf evergreen tree, SD	30m (100ft)	white or pinkish	aged bark brownish-red and peeling
<i>Quercus garryana</i> (Garry oak)	Deciduous tree, SD	25m (80ft)	inconspicuous	broad spread; produces acorns
<i>Ribes sanguineum</i> (red-flowering currant)	Deciduous shrub	3m (10ft)	light to dark rose, rarely white	blue-black fruit; leaves fragrant
<i>Achillea millefolium</i> (yarrow)	Perennial	1m (3ft)	white to cream to pinkish-red	leaves fragrant, used in teas
<i>Camassia leichtlinii</i> (great camas)	Perennial, SD	1m (3ft)	pale to deep blue, rarely white	bulbs edible when cooked
<i>Lomatium nudicaule</i> (barestem desert-parsley)	Perennial, some shade	90cm (36in)	yellow	young leaves edible raw or cooked
<i>Fritillaria affinis</i> (chocolate lily)	Perennial	80cm (32in)	brownish-purple to yellowish-green;	bulbs edible when cooked
<i>Camassia quamash</i> (common camas)	Perennial, SD	70cm (28in)	pale to deep blue, rarely white	bulbs edible when cooked
<i>Delphinium menziesii</i> (Menzies' larkspur)	Perennial	70cm (28in)	purple to blue to white	
<i>Triteleia hyacinthina</i> (white triteleia)	Perennial	60cm (24in)	white often tinged with blue, to light blue, with green mid-veins	
<i>Allium cernuum</i> (nodding onion)	Perennial	50cm (20in)	pink to rose-purple or whitish	bulb, leaves, flowers and seeds edible
<i>Dodecatheon pulchellum</i> (few-flowered shooting-star)	Perennial, SD	45cm (18in)	multi-coloured: pink to reddish-purple, yellow and white	
<i>Penstemon fruticosus</i> (shrubby penstemon)	Broadleaf evergreen shrub	40cm (16in)	blue-lavender to light purple	
<i>Erythronium oregonum</i> (white fawn lily)	Perennial, SD	35cm (14in)	white with yellow-orange base	
<i>Allium acuminatum</i> (Hooker's onion)	Perennial	30cm (12in)	rose-pink to whitish	bulb, leaves, flowers and seeds edible
<i>Olsynium douglasii</i> (satinflower)	Perennial, SD	30cm (12in)	reddish-purple	
<i>Potentilla villosa</i> (villous cinquefoil)	Perennial	30cm (12in)	yellow	
<i>Sedum spathulifolium</i> (broad-leaved stonecrop)	Perennial succulent	20cm (8in)	bright yellow	
<i>Arctostaphylos uva-ursi</i> (kinnikinick)	Broadleaf evergreen shrub	15cm (6in)	pinkish-white	bright red fruit edible; groundcover
<i>Sedum oregonum</i> (Oregon stonecrop)	Perennial succulent	15cm (6in)	yellow becoming pinkish	
<i>Fragaria chiloensis</i> (coastal strawberry)	Evergreen perennial	trailing	white	need male and female plants to make fruit;
Warning: Species with edible bulbs should not be confused with <i>Zygadenus venenosus</i> or death camas which is poisonous .				

The Government of British Columbia enacted a law in 1996 to protect three iconic coastal rainforest plants - a tree, a shrub and a perennial: the **Western flowering dogwood**, *Cornus nuttallii*, **Pacific rhododendron**, *Rhododendron macrophyllum*, and **western trillium**, *Trillium ovatum*. The law prohibited actions that would reduce their populations such as removing the plants or picking their flowers, which prevents them from producing seed. The law was rescinded in 2002 however the plants and their habitats are still vulnerable to disturbance.

PACIFIC NORTHWEST NATIVE PLANTS

Part Sun - Part Shade | Moderately Dry to Moist Soil

Plant Name	Type Preferred Exposure	Max. Height	Flowers	Other Features
<i>Amelanchier alnifolia</i> (Saskatoon)	Deciduous shrub, sun or shade	6m (20ft)	white	purple to blackish fruit edible
<i>Sambucus cerulea</i> (blue elderberry)	Deciduous shrub	5m (16ft)	white or cream	powder blue fruit edible when cooked
<i>Ribes sanguineum</i> (red-flowering currant)	Deciduous shrub, sun	3m (10ft)	light to dark rose, rarely white	blue-black fruit not edible
<i>Vaccinium ovatum</i> (evergreen huckleberry)	Broadleaf evergreen shrub, sun	3m (10ft)	bright pinkish	deep purplish-black fruit edible
<i>Mahonia aquifolium</i> (tall Oregon-grape)	Broadleaf evergreen shrub	2.5m (8ft)	yellow	blue fruit edible
<i>Gaultheria shallon</i> (salal)	Broadleaf evergreen shrub	1.5m (5ft)	white to pinkish	purplish-black fruit edible
<i>Vaccinium membranaceum</i> (black huckleberry)	Deciduous shrub	1.5m (5ft)	pale yellowish-pink	purple or dark purplish-reddish fruit edible
<i>Lilium columbianum</i> (tiger lily)	Perennial, sun	1.2m (3ft)	yellow-red to reddish-orange with dark red or purple spots	
<i>Eurybia conspicua</i> (showy aster)	Perennial	1m (3ft)	blue to violet with yellow	
<i>Penstemon ovatus</i> (broad-leaved penstemon)	Perennial	1m (3ft)	deep blue	
<i>Campanula rotundifolia</i> (common harebell)	Perennial	80cm (32in)	blue	
<i>Mahonia nervosa</i> (dull Oregon grape)	Broadleaf evergreen shrub	60cm (24in)	yellow	blue fruit edible
<i>Sisyrinchium idahoense</i> (Idaho blue-eyed grass)	Perennial, sun	40cm (16in)	pale blue to purple, or deep violet-purple	
<i>Erythronium revolutum</i> (pink fawn lily)	Perennial, summer-wet	35cm (14in)	rose-pink with yellow base	
<i>Trientalis latifolia</i> (northern starflower)	Perennial	25cm (10in)	pinkish to whitish	
<i>Arctostaphylos uva-ursi</i> (kinnikinnick)	Broadleaf evergreen shrub	15cm (6in)	pinkish-white	bright red fruit edible; groundcover
<i>Fragaria vesca</i> (wood strawberry)	Perennial	trailing	white	red fruit edible
<i>Fragaria virginiana</i> (wild strawberry)	Perennial, sun	trailing	white	red fruit edible

Part Sun – Part Shade | Moist to Very Moist Soil

Plant Name	Type Preferred Exposure	Max. Height	Flowers	Other Features
<i>Tsuga mertensiana</i> (mountain hemlock)	Coniferous tree	40m (130ft)	not applicable	stays small for years; very slow growing
<i>Cornus nuttallii</i> (western flowering dogwood)	Deciduous tree, shade roots	20m (65ft)	white or pinkish bracts; petals greenish-white, purplish-tinged	
<i>Acer circinatum</i> (vine maple)	Deciduous tree, shade or sun	8m (26ft)	white and red, small	golden to bright red leaves in fall
<i>Rubus spectabilis</i> (salmonberry)	Deciduous shrub	4m (13ft)	rosy red to reddish-purple	yellow, salmon or dark red fruit edible
<i>Vaccinium parvifolium</i> (red huckleberry)	Deciduous shrub, shade	4m (13ft)	yellowish-pink	bright red fruit edible
<i>Rosa nutkana</i> (Nootka rose)	Deciduous shrub	3m (10ft)	pink	purplish-red fruit edible when cooked
<i>Rubus parviflorus</i> (thimbleberry)	Deciduous shrub	2.5m (8ft)	white	red fruit edible
<i>Vaccinium ovalifolium</i> (oval-leaved blueberry)	Deciduous shrub, shade	2m (7ft)	pinkish	purplish-black to bluish-black fruit edible
<i>Aruncus sylvester</i> (goatsbeard)	Perennial	2m (7ft)	white	
<i>Gaultheria shallon</i> (salal)	Broadleaf evergreen shrub	1.5m (5ft)	white to pinkish	purplish-black fruit edible
<i>Polystichum munitum</i> (sword fern)	Evergreen fern	1.5m (5ft)	not applicable	
<i>Streptopus amplexifolius</i> (clasping twistedstalk)	Perennial	1.2m (3ft)	greenish-white to yellowish-green	yellow to red fruit, aging to dark purple
<i>Aquilegia formosa</i> (Sitka or red columbine)	Perennial	1m (3ft)	pale to deep red and yellow	
<i>Maianthemum racemosum</i> (false Solomon's-seal)	Perennial	1m (3ft)	white, fragrant	mottled green to red fruit
<i>Mimulus lewisii</i> (pink monkey-flower)	Perennial	1m (3ft)	pink-purple to rose-red	
<i>Prosartes hookeri</i> (Hooker's fairybells)	Perennial, shade	1m (3ft)	creamy white	yellow turning to red fruit not edible

PACIFIC NORTHWEST NATIVE PLANTS

Part Sun – Part Shade | Moist to Very Moist Soil

Plant Name	Type Preferred Exposure	Max. Height	Flowers	Other Features
<i>Thalictrum occidentale</i> (western meadowrue)	Perennial	1m (3ft)	greenish-whitish, purplish-tinged	
<i>Castilleja miniata</i> (scarlet paintbrush)	Perennial	80cm (32in)	bright red or scarlet to orange bracts	
<i>Erigeron speciosus</i> (showy daisy)	Perennial, sun	80cm (32in)	blue, lavender or white and yellow	
<i>Mimulus guttatus</i> (yellow monkey-flower)	Perennial, sun	80cm (32in)	yellow with maroon markings	
<i>Tellima grandiflora</i> (tall fringe-cup)	Perennial	80cm (32in)	greenish-white to rose	
<i>Adiantum aleuticum</i> (northern maiden-hair)	Deciduous fern	75cm (30in)	not applicable	
<i>Penstemon serrulatus</i> (coast penstemon)	Perennial	70cm (28in)	deep blue to purple	
<i>Blechnum spicant</i> (deer fern)	Evergreen fern, shade	60cm (24in)	not applicable	
<i>Heuchera micrantha</i> (small-flowered alumroot)	Perennial	60cm (24in)	white	
<i>Polypodium glycyrrhiza</i> (licorice fern)	Evergreen fern	60cm (24in)	not applicable	rhizomes licorice-flavoured
<i>Allium geberi</i> (Geyer's onion)	Perennial, sun	50cm (20in)	pink, rarely white	bulb, leaves, flowers and seeds edible
<i>Tiarella trifoliata</i> (three-leaved foam-flower)	Perennial	50cm (20in)	white	
<i>Trillium ovatum</i> (western trillium)	Perennial	45cm (18in)	white aging to pale pink to purple	
<i>Iris tenax</i> (Oregon iris)	Perennial, sun	40cm (16in)	blue to purple or lavender, occas. white to pinkish or yellow	
<i>Erythronium revolutum</i> (pink fawn lily)	Perennial, summer-wet	35cm (14in)	rose-pink with yellow base	
<i>Maianthemum dilatatum</i> (False lily-of-the-valley)	Perennial, shade	35cm (14in)	cream to white	red fruit; groundcover
<i>Achlys triphylla</i> (vanilla leaf)	Perennial, shade	30cm (12in)	white	dried leaves fragrant
<i>Cornus canadensis</i> (bunchberry)	Perennial, shade	25cm (10in)	white to pinkish or purplish-tinge	bright coral red fruit edible; groundcover
<i>Gymnocarpium dryopteris</i> (oak fern)	Deciduous fern, shade	25cm (10in)	not applicable	
<i>Vaccinium vitis-idaea</i> (lingonberry)	Broadleaf evergreen shrub	trailing	pinkish	bright red fruit edible; groundcover
<i>Asarum caudatum</i> (wild ginger)	Perennial, shade	mat forming	purplish-brown to greenish-yellow	roots and leaves edible

Part Sun – Part Shade | Very Moist to Wet Soil

Plant Name	Type Preferred Exposure	Max. Height	Flowers	Other Features
<i>Malus fusca</i> (Pacific crab apple)	Deciduous tree, sun	8m (26ft)	white to pink	yellow to reddish or purplish fruit edible
<i>Crataegus douglasii</i> (black hawthorn)	Deciduous tree	7m (23ft)	white	blackish-purple fruit edible cooked
<i>Rubus spectabilis</i> (salmonberry)	Deciduous shrub	4m (13ft)	rosy red to reddish-purple	yellow, salmon or dark red fruit edible
<i>Sidalcea hendersonii</i> (Henderson's checker-mallow)	Perennial, sun	1.5m (5ft)	deep pink	
<i>Matteuccia struthiopteris</i> (ostrich fern)	Fern	1.4m (4ft)	not applicable	young fiddlehead fronds edible cooked
<i>Mimulus lewisii</i> (pink monkey-flower)	Perennial	1.0m (3ft)	pink-purple to rose-red	
<i>Mimulus guttatus</i> (yellow monkey-flower)	Perennial, sun	80cm (32in)	yellow with maroon markings	
<i>Sanguisorba menziesii</i> (Menzies' burnet)	Perennial	80cm (32in)	reddish-purple to pink	
<i>Lysichiton americanum</i> (skunk cabbage)	Perennial	70cm (28in)	yellowish bracts	greenish to reddish fruit not edible
<i>Iris setosa</i> (wild flag)	Perennial	70cm (28in)	blue	
<i>Boykinia elata</i> (coast boykinia)	Perennial, shade	60cm (24in)	white	
<i>Sisyrinchium californicum</i> (golden-eyed grass)	Perennial, sun	60cm (24in)	yellow	
<i>Menyanthes trifoliata</i> (buckbean)	Perennial, sun	40cm (16in)	white, purple-tinged	trailing
<i>Viola glabella</i> (stream violet)	Perennial, shade or sun	30cm (12in)	deep yellow, purplish markings	

RHODODENDRONS AND AZALEAS

Over 150 varieties of rhododendrons and azaleas (deciduous and evergreen) are available.

Rhododendrons and Azaleas—Bloom times are approximate and will vary with location and season.

Plant Name	Height	Colour	Bloom	Information
<i>Rhododendron</i> ‘Anah Kruschke’	2m (6ft)	pale, lavender-blue to reddish-purple with purple-red spots	May 15-June 15	Attractive plant has compact habit, grows well in full sun. Dense and lush foliage with dark green leaves
<i>R. augustinii</i> ‘Hobbie’	90cm (3ft)	light blue	Apr-May	Outstanding as a landscape accent
<i>R.</i> ‘Azurro’	1.2m (4ft)	deep to strong purple, tinged deep reddish-purple, with a dark red blotch	June 1-June 15	Dark glossy green foliage covering its tighter, compact shape
<i>R.</i> ‘Barmstedt’ (<i>yakushmanum</i> hybrid)	90cm (3ft)	shiny red fading to rose with a bit of darker red inside that fades to a lighter pink	May 1-June 1	New growth has silvery indumentum. As season progresses, foliage changes to deep, luscious green. Tough, compact plant
<i>R.</i> ‘Blue Baron’	60cm (2ft)	light violet inside, vivid violet outside	Apr 15-May 1	A lovely plant with glossy, green foliage in summer and bronze in winter. Quite compact, and hardy
<i>R. campylogynum</i>	60cm(2.5ft)	waxy pink flowers	Apr-May	An aromatic shrub with small leaves
<i>R. campylogynum</i> dwarf	60cm (2ft)	little waxy bell-shaped flowers of dusty-rose	Apr-May	Very sweet dwarf, with small, extremely aromatic leaves
<i>R. camtschaticum</i>	30cm (1ft)	cerise-pink single star flowers	Mar 15-Apr 15	Hardy dwarf; obovate to spatulate leaves with bristly margins
<i>R.</i> ‘Capistrano’	1.2m (4ft)	chartreuse-yellow	May 1-June 1	One of the best hardy, yellow rhododendrons
<i>R.</i> ‘Carmen’	30cm (1ft)	waxy, dark red, fine, slightly deeper veins	Apr 15-May 1	Terrific green foliage on a lovely, compact, mounded plant
<i>R.</i> ‘Checkmate’	2m (6ft)	masses of small, lavender-pink flowers	Mar 15-Apr 15	Dwarf plant that has beautiful dark, mahogany, winter foliage
<i>R.</i> ‘Cherries & Merlot’	90cm (3ft)	glowing red	Apr 15-May 1	Leaves blue-green top, amazing burgundy-purple-red underneath
<i>R.</i> ‘Cherry Cheesecake’	1.5m (5ft)	white flowers with red edges and red blotch	Apr-May	Good size flowers and large, lush, mounding foliage
<i>R. cinnabarinum</i>	1.3m (4ft)	yellow/orange bud opening to a deep coral-red	Apr-May	Foliage is aromatic
<i>R.</i> ‘Cream Crest’	90cm (3ft)	bright creamy-yellow	Apr 15-May 1	Compact in habit, likes sun, good foliage. Hardy and vigorous
<i>R.</i> ‘Crete’ (<i>yakushmanum</i> hybrid)	1.2m (4ft)	magenta-rose buds open to very light purple flowers with a few light spots	May 1-June 1	Has soft beige indumentum
<i>R.</i> ‘Cunningham’s Blush’	1.3m (4ft)	very light pink kissed with a yellow-pink blotch on the upper lobe	May 1-June 15	Good grower and bloomer; habit is tight and rounded
<i>R.</i> ‘Cunningham’s White’	1.2m (4ft)	buds flush pink-mauve, fading to white, broad pale yellow-green-brown markings	May 1-June 15	Attractive, spreading, compact, well branched; will tolerate sunny position but prefers shade. Sometimes blooms in autumn
<i>R.</i> ‘Edith Bosley’	1.3m (4 ft)	deep purple accented by a darker eye	Apr-May	Hardy with large blooms
<i>R.</i> ‘Elizabeth Ostbo Red’	90cm (3ft)	scarlet-red flowers	April (occ. Sept)	Red foliage when new, fading to deep green
<i>R.</i> ‘Everred’	60cm (2ft) 90cm (3ft)	red	April	One of the darkest red-purple leaved rhododendron to date; leaves so dark they sometimes appear almost black
<i>R.</i> ‘Fantastica’ (<i>yakushmanum</i> hybrid)	90cm (3ft)	strong rose colour fading to white in throat, light citron-green spotting inside	May 1-June 1	Flowers very heavily on a rounded, vigorous-growing plant with woolly indumentum beneath long, elliptic leaves
<i>R.</i> ‘Golden Torch’	1.2m (4ft)	warm pink buds open to a soft yellow flower	May 1-June 15	Deep green fol. has light kiss of brown indumentum on underside
<i>R.</i> ‘Hachmann’s Picobello’ (<i>yak.</i> hybrid)	1.5m (5ft)	white as snow with a blackberry eye	June 1-June 15	Small and compact with beautiful glossy, dark green foliage
<i>R.</i> ‘Hachmann’s Polaris’ (<i>yakushmanum</i> hybrid)	90cm (3ft) 1.2m (4ft)	ruffled, ruby-pink flowers with soft pink centres that bloom profusely in spring	Apr 1-May 1	Flowers heavily at young age, and forms a low, compact mound with dense, elliptic, very hairy foliage. Wind and sun tolerant
<i>R.</i> ‘Hansel’	90cm (3ft)	salmon-orange flowers	May 1-June 1	Very good foliage with buff-coloured indumentum under leaves

RHODODENDRONS AND AZALEAS

Plant Name	Height	Colour	Bloom	Information
<i>R.</i> 'Hellikki'	1.5m (5ft)	purple-red flowers	June 1-June 15	Yellowish indumentum covers buds and new foliage, and persists on the undersides of mature leaves. Very hardy
<i>R.</i> 'Honey Butter'	1.5m (5ft)	luscious tones of yellow with apricot edging	May	Beautiful plant with dome-shaped trusses
<i>R.</i> 'Horizon Monarch'	2m (6ft)	red buds open amber-yellow w small, red flare	May 1-June 1	Flowers and leaves are very heavy textured
<i>R. impeditum</i>	30cm (1ft)	purple	Apr 15-May 1	Dwarf with attractive silver-grey foliage
<i>R.</i> 'Ingrid Mehlquist' (<i>yakushmanum</i> hybrid)	60cm (2ft)	ruffled soft pink, maturing to pure white, with burgundy blotch	May 1-June 1	Has slightly fragrant flowers and leaves have slight bronze indumentum
<i>R.</i> 'Janet Blair'	2m (6ft)	frilled light-pink with distinctive green flare on upper petal	May 1-June 1	Vigorous, good-looking plant
<i>R.</i> 'Jean Marie de Montague'	1.5m (5ft)	bright red flowers	May 1-June 1	Thick, heavy foliage is sun tolerant, and the deep emerald-green unmatched by many plants. Buds young
<i>R.</i> 'Kabarett'	1.2m (4ft)	large, frilled, lilac-pink to orchid flowers with huge burgundy blotch	May 1-June 1	The foliage is shiny, deep green and stems are reddish. Has rounded habit
<i>R.</i> 'Karin Seleger'	60cm(2.5ft)	medium violet-purple	May 1-June 1	An extremely hardy and very compact plant
<i>R. kelecticum</i>	30cm (1ft)	rose-purple flowers	Apr 1-May 1	Good for bonsai. Tight compact, semi-prostrate dwarf species
<i>R.</i> 'Kodiak' (<i>yakushmanum</i> hybrid)	1.2m (4ft)	silvery-white bell trusses with some slight spotting in throat	May 1-June 1	Plant that has been described as "terrific, just plain gorgeous"
<i>R.</i> 'Lee's Dark Purple'	2m (6ft)	deep, dark purple	May 15-June 15	This is an old reliable hybrid and popular for many years. The foliage is handsome, dark and wavy
<i>R.</i> 'Lemon Dream' (<i>yakushmanum</i> hybrid)	30cm (1ft)	abundant, soft true yellow wavy-edged flowers (sometimes double)	May 1-June 1	Foliage is rounded and dark green with a bit of brownish-orange indumentum on the underside. Low, mounded habit
<i>R.</i> 'Medusa'	90cm (3ft)	bell-shaped, pendulous, orange and coral flowers	May 1-June 1	Leaves are mid-sized and greyish-green, with a very light woolly indumentum on the undersides
<i>R.</i> 'Melrose Flash'	1.5m (5ft)	very bright, bi-colour flowers; creamy-ivory dressed with broad, pink margins and green eye	May 1-June 1	Foliage exhibits good heat tolerance. The plant will grow wider than tall, and blooms heavily and reliably
<i>R.</i> 'Milton'	1.5m (5ft)	orange to pink	Mid to late May	Requires a fairly sunny position
<i>R.</i> 'Nancy Evans'	90cm (3ft)	amber-yellow, becoming rich golden-yellow	May 1-Jun 1	Good foliage and produces a magnificent plant. Flowers young
<i>R. mucronulatum</i> 'Cornell Pink'	1.2m (4ft)	clear pink	April	The soft-green foliage turns yellow and bronze in fall. Well-branched habit
<i>R.</i> 'Nova Zembla'	1.5m (5ft)	bright red with black spots	May 1-June 1	Hardy vigorous grower with good foliage
<i>R.</i> 'Patty Bee'	45cm(18in)	clear yellow	Apr 15-May 1	Dwarf variety that tolerates both heat and sun
<i>R. pemakoense</i>	45cm(18in)	soft pink flowers with crimson spots	Apr 1-May 1	Long-growing, spreading shrub, with long, funnel-shaped dull-green leaves. Heavy-flowering dwarf. Compact and semi-erect
<i>R.</i> 'Percy Wiseman' (<i>yakushmanum</i> hybrid)	90cm (3ft)	peach-yellow that gently fades to white	May 1-June 1	Compact plant with dark green foliage
<i>R.</i> 'Polarnacht'	90cm (3ft)	frilly, dark purple, with spotted, red throat	May 1-June 15	Dark elliptic leaves. Plant is almost twice as wide as tall
<i>R.</i> 'Pomegranate Splash'	1.5m (5ft)	funnel-shaped pale purple-pink inside, dark red margin. Prominent purple-red blotch on dorsal lobe has lots of spotting radiating out	May 1-June 15	The large upright trusses can be composed of as many as 14 flowers. A great plant for the garden

RHODODENDRONS AND AZALEAS

Plant Name	Height	Colour	Bloom	Information
<i>R.</i> 'Purple Passion'	1.5m (5ft)	deep purple trusses, white flare on upper lobe	May	Glorious, compact bush that offers colour and style in the garden
<i>R.</i> 'Purpureum Elegans'	1.5m (5ft)	dark blue-purple flowers	May 1-June 1	Hardy, vigorous, upright, with medium green and glossy foliage
<i>R.</i> 'Rabatz'	1.2m (4ft)	deep red	May	Short stamens for rich presentation of deep red flower colour
<i>R.</i> 'Ramapo'	60cm (2ft)	tiny, inch-long flowers are lively, pink-violet	Apr 15-May 1	Hardy dwarf, grows well in sun or partial shade
<i>R.</i> 'Red Eye'	1.5m (5ft)	deep red-purple flowers with an interesting 'eye' blotch	May-June	A good reliable shrub with rich green leaves, that is very tolerant of many conditions
<i>R.</i> 'Saffrano'	90cm (3ft)	showy, orange buds open to soft yellow, trumpet-shaped flowers	Mar-Apr	Wonderful evergreen shrub with dark green glossy foliage
<i>R.</i> 'Scintillation'	1.5m (5ft)	pink with green and bronze markings	May 1-June 1	Broad, well-branched shrub, sturdy stems, heavy bloomer. Shiny green foliage, curls interestingly and has a heavy, waxy texture
<i>R.</i> 'Tapestry'	1.2m (4ft)	deep lavender accented by darker eyes	May 1-June 1	Low growing and spreading, this plant is densely covered with forest-green foliage
<i>R.</i> 'Teacher's Pet'	60cm (2ft)	peachy-orange	Mid April	Low-growing plant sporting dark green leaves
<i>R.</i> 'Thor'	90cm (3ft)	bright, scarlet-red flowers have a large calyx	May 1-June 1	Good, compact habit and thick indumentum on leaf underside
<i>R.</i> 'Tortoise Shell'	1.5m (5ft)	orange-salmon flowers	April 1-May 1	A dense, upright, evergreen shrub with deep green foliage
<i>R.</i> 'Wren'	30cm (1ft)	abundant clear yellow flowers	May 1-June 1	Very low-growing, creeping plant with shiny leaves that turn bronze-red in winter
<i>R.</i> 'Yaku Prince' (<i>yakushmanum</i> hybrid)	60cm (2ft)	pink flowers, blotched paler pink with reddish-orange spotting, fading lighter	May 1-June 15	Magnificent blooms, deep green foliage coated with indumentum on the undersides, producing a suede-like effect
<i>R.</i> 'Yaku Princess' (<i>yakushmanum</i> hybrid)	90cm (3ft)	apple-blossom pink, accents are a rosy-pink blush with greenish spots that fade lighter	May 1-June 15	Medium size foliage

Volunteering at VanDusen

We endeavour to provide our members with a variety of opportunities to build new skills, make friends and help the Garden grow. We have volunteer opportunities for all interests. Please join us at an upcoming volunteer orientation to find out more.

Opportunities include: Education, Guides, Master Gardeners, School Program Leaders, Summer Nature Program Leader, Teaching Assistants, Clerical Activities, Office Assistance, Garden Activities, Dried Flower Arrangers, Garden Guerillas, Garden Shop, Labellers, Library, Seed Collectors, Public Relations, Community Ambassadors, Customer Services, Membership, Visitor Services, Special Events, Compost Sale, Festival of Lights, Manure Sale and, of course, the Plant Sale.

TREES AND SHRUBS

Plant Name	D/EG	Height	Colour	Bloom	Expos.	Frag	Z	Information
<i>Abeliophyllum distichum</i> 'Roseum Group'	D	1-1.2m (3-5ft)	pink/white	late wint	☼○	yes	5	Arching branches, very early flowering in Feb
<i>Acer cissifolium</i> (ivy leafed maple)	D	6m (18ft)		spring	☼○		4	Trifoliate ivy like leaves, rounded form, vivid fall col
<i>Acer davidii</i> (David snakebark maple)	D	10m (30ft)		spring	☼○		5	White streaks on jade green bark. Simple leaf, fall col
<i>Acer griseum</i> (paperbark maple)	D	6m (18ft)		spring	☼○		5	Peeling crimson bark, vivid fall colour
<i>Acer japonicum</i> 'Aconitifolium'	D	5m (15ft)	scarlet	fall col	☼○		5	Upright, multi branch, deeply dissected leaf
<i>Acer palmatum</i> 'Aratama' *	D	1-2m (3-6ft)	yell/oran	fall col	☼○		5	Dwarf, bright red to light purple red foliage, green ribs
<i>Acer palmatum</i> 'Chishio' *	D	2.5 m (8ft)	orange/red	fall col	☼○		5	Pink in spring, elegant branching habit
<i>Acer palmatum</i> 'Emperor 1' (red leaf maple)*	D	5m (15ft)	dark crim	fall col	☼○		5	Compact, classic, upright red
<i>Acer palmatum</i> 'Ki Hachijo'	D	4-6m (20-24ft)	gold/rose	fall col	☼○		5	Well rounded, short tree, bright green palmate leaf
<i>Acer palmatum</i> 'Koto-no-ito' (dwarf Japan. maple) *	D	2m (6ft)	yellow	fall col	☼○		5	Green linear leaf form, yellow fall colour
<i>Acer palmatum</i> 'Mikawa Yatsubusa' *	D	1m (3ft)	golden	fall col	☼○		5	Dwarf, bonsai, leaf nodes very close together, dense
<i>Acer palmatum</i> 'Okagami' *	D	4-6m (20-24ft)	scarlet	fall col	☼○		5	Upright, spring purplish-red, then shiny black-red leaf
<i>Acer palmatum</i> 'Orange Dream' *	D	2-4 m (6-14ft)	gold	fall col	☼○		5	Upright green form, spring foliage fresh, orange/lemon
<i>Acer palmatum</i> 'Pixie' *	D	1-2m (3-6ft)	scarlet	fall col	☼○		5	Round form, red, spring foliage bright pink-red
<i>Acer palmatum</i> 'Red Pygmy' *	D	1.5-2m (4-7ft)	yell/gold	fall col	☼○		5	Upright, rounded form, linear red leaf
<i>Acer palmatum</i> 'Red Spider' *	D	3-6m (10-24ft)	blood red	fall col	☼○		5	Upright, branch tips curve down, linear red leaf
<i>Acer palmatum</i> 'Samurai' * (syn' Aka shigitatsu sawa')	D	3-4m(10-18ft)	red	fall col	☼○		5	Upright, bushy, variegated green veins, pink edges
<i>Acer palmatum</i> 'Shaina' *	D	2-4 m (6-14ft)	crimson	fall col	☼○		5	Compact upright, leaves cluster at tips of branches
<i>Acer palmatum</i> 'Shishigashira'*(lions head maple)	D	2.5m (8ft)	burg/gold	fall col	☼○		5	Compact, stubby growth, looks like a lions mane
<i>Acer palmatum</i> 'Tsukushigata' *	D	4-6m (18-24ft)	fiery red	fall col	☼○		5	Black-purple foliage, green veins, wide grower
<i>Acer palmatum</i> 'Ukigumo' *	D	2-4 m (6-14ft)			☼○		5	Variegated, floating clouds, outstanding form
<i>Acer palmatum</i> 'Villa Taranto' *	D	2-4m (6-9ft)	gold/oran	fall col	☼		5	Green domed form, linear green-purple leaf, golden-orange fall colour
<i>Acer palmatum dissectum</i> 'Crimson Queen' *	D	2-4m (6-9ft)	scarlet	fall col	☼○		5	Mound, red leaf, ages into cascading form, holds red
<i>Acer palmatum dissectum</i> 'Garnet' *	D	4-5m(12-15ft)	red	fall col	☼		5	Cascading mounding habit, rich red leaf, red in sun
<i>Acer palmatum dissectum</i> 'Inaba Shidare' *	D	4m (12ft)	purple/red	fall col	☼○		5	More upright growing, dissectum, red
<i>Acer palmatum dissectum</i> 'Seiryu' (lace leaf) *	D	4m (12ft)	gold	fall col	☼		5	Unusual, fine green foliage. Orange fall colour
<i>Acer palmatum dissectum</i> 'Tamuke Yama'*	D	2-4m (6-9ft)	scarlet	fall col	☼○		5	Mound, cascading, new growth deep crimson, then dk ppl
<i>Acer palmatum dissectum</i> 'Viridis' *	D	2.5 m (8ft)	gold/crim	fall col	☼○		5	Green cascading, lace leaf
<i>Acer palmatum dissectum</i> 'Water Fall' *	D	2-4m (6-9ft)	gold/crim	fall col	☼○		5	Strong cascading, takes full sun well, leaves flowing
<i>Acer rufinerve</i> (snake bark maple)	D	9m (40ft)			☼○		5	White streaks on bark, shallow trilobe leaf
<i>Acer shirasawanum</i> 'Aureum' *	D	4-8m (12-35ft)	gold/red	fall col	☼○		5	Golden full-moon maple, slow grower, best yellow
<i>Acer shirasawanum</i> 'Autumn Moon' *	D	2-3m (6-9ft)	orange/red	fall col	☼		5	Burn orange foliage, shaded leaves yellow/green, slow
<i>Araucaria araucana</i> (Monkey puzzle tree)	EG	27m (90ft)			☼		7	Slow grower, female, large cone 18", edible nut
<i>Arbutus unedo</i> 'Compacta' *	EG	2 n (6ft)	white	fall	☼○		7	Slow grower, red fruit in fall, drought tolerant
<i>Berberis sieboldii</i>	D	1.2m (4ft)	yellow	spring	☼		4?	Almost thornless berberis, green leaf, red fall colour
<i>Berberis thunbergii</i> 'Concorde' *	D	.75m (2ft)	yellow	spring	☼		4	Compact, deep burgundy-purple foliage, red fall colour

TREES AND SHRUBS

Plant Name	D/EG	Height	Colour	Bloom	Expos.	Frag	Z	Information
<i>Berberis thunbergii</i> 'Rose Glow' (barberry)*	D	2m (6ft)	yellow	spring	☼		4	Slow grower, new foliage, red, pink, white
<i>Buddleia</i> 'Santana'	D	2m (6ft)	purple	summer	☼☉	yes	5	Golden variegated foliage, deep purple
<i>Buddleia</i> 'Tutti Fruti'	D	1m (2-3ft)	magenta	summer	☼☉	yes	5	Dwarf, deer and drought tolerant. Attracts butterflies
<i>Buddleia davidii</i> 'Buzz Ivory'	D	1m (3-4ft)	white	summer	☼☉	yes	5	Grey-green foliage, compact, long, cone-shaped flower clusters. Attracts butterflies. Dry conditions
<i>Callicarpa bodinieri</i> 'Profusion'	D	2 m (6ft)	pink	summer	☼☉		6	Purple fruit in fall, heavy fruiting cultivar
<i>Calluna vulgaris</i> 'Firefly' (Scottish heather)	EG	15cm(6 inch)	lavender	sum-fall	☼		4	Golden foliage pink flowers, upright
<i>Calluna vulgaris</i> 'Multicolour'	EG	15 cm(6inch)	pink	sum-fall	☼		4	Golden foliage turns pink and gold in fall
<i>Calluna vulgaris</i> 'Winter Chocolate'	EG	30cm (12 inch)	lavendar	sum-fall	☼		4	Gold foliage, pink tips in winter
<i>Calycanthus floridus</i>	D	2m (6ft)	maroon	spring	☼☉	yes	5	Strong musky, fragrant flower, magnolia relative
<i>Camellia japonica</i> 'Red Lily' *	EG		red	spring	☼☉		7	Tubular single, deep pink-red, mid season, very small
<i>Camellia oleifera</i> *	EG	3m (10ft)	cream	spring	☼☉	yes	7?	Tea oil camellia, scented, may bloom early winter
<i>Camellia sasanqua</i> 'Kanjiro' *	EG	2-3m (6-10ft)	rose-pink	winter	☼☉	yes	8	Semi double flowers, drought resistant
<i>Camellia sinensis</i> 'Blushing maiden' *	EG	1-3m (3-10ft)	pink	fall	☼☉	yes	7b	Single pink, red blush to leaves, red seed pods
<i>Camellia sinensis</i> 'Teabreeze' *	EG	2-3m(7-10ft)	white	fall	☼☉	yes	7b	Single nodding white flower, fragrant.Piroche selection
<i>Camellia sinensis</i> *	EG	2m (6ft)	white	fall	☼☉	yes	6	Famous plant where all tea originates. Seed grown
<i>Carya illinoensis</i> (Northern pecan)	D	10m (30ft)	white	spring	☼		5	Sweet edible nuts. Hardy, tropical looking, self fertile
<i>Carya ovata</i> (shagbark hickory)	D	20m (60ft)	white	spring	☼		4	Sweet edible nuts. Tropical looking. Self fertile
<i>Castanea dentata</i> (American chestnut)	D	30m (90ft)	white	spring	☼		5	Rare. Sweet edible protein-rich nuts. 2 for pollination
<i>Ceanothus gloriosus</i> 'Point Reyes' *	EG	.5m (2ft)	blue	spring	☼		7b ?	Small leathery holly-like leaves, minimal water in summer, good drainage. To -9C. Endemic to bluffs
<i>Ceanothus</i> x 'Blue Sapphire' *	EG	1m (3ft)	blue	spring	☼		8?	Low grower, trail over a rockery, deep blue flower
<i>Ceanothus</i> x <i>pallidus</i> 'Marie Simon'	D	1-1.2m (3-5ft)	pink	spr/sum	☼		6a	Semi deciduous, big billowy pink flower clusters
<i>Chamaecyparis obtusa</i> 'Fernspray Gold' *	Con	3-4m(9-12ft)			☼		4	Slow grower, open habit, pyramidal, gold tip foliage
<i>Chamaecyparis obtusa</i> 'Kamaeni Hibi' *	Con	.75-1.25m (2-4			☼☉		5a	Dwarf slow growing, dainty, golden, twisted foliage
<i>Chamaecyparis obtusa</i> 'Marianne' *	Con	.75-1m (2-3ft)			☉		5	Slow growing, upright greenish yellow foliage
<i>Chamaecyparis obtusa</i> 'Mariesii' *	Con	1m (3ft)			☼☉		5	Creamy-white and green variegation, slow grower
<i>Chamaecyparis obtusa</i> 'Nana Gracilis' *	EG	1.5m (4ft)	conifer		☼☉		6	Slow grower, foliage in shell-like sprays
<i>Choisya ternata</i> 'Goldfinger'*	EG	1-3 m (3-6ft)	white	May	☼☉	yes	7	Golden foliage, narrow leaf like 'Aztec Pearl'
<i>Choisya ternata</i> (Mexican mock orange)*	EG	1-3m (3-6ft)	white	e. spring	☼☉	yes	7	Likes fast drainage, sun. Can be a bit leggy in shade
<i>Choisya</i> x <i>dewitteana</i> 'Aztec Pearl' *	EG	1-3m (3-6ft)	white/pink	May	☉	yes	7	Crow-foot leaf, narrow leaflets. Large flowers
<i>Chusquea gigantea</i> *	EG	5-6m (15-20ft)	grass		☼☉		7	Hardy, South American clumping bamboo, container
<i>Clethra alnifolia</i> (Sweet pepperbush) *	D	1-2m (3-8ft)	white	summer	☼☉	yes	3	Ok in wet soils, upright panicle frag. Attracts butterflies
<i>Coprosma</i> 'Black Cloud' *	EG	.25-1.25m(1-4f	white	spr/sum	☼☉		8	Mirror plant, glossy reflective leaves, black in cool conditions, great foliage shrub. Drought tolerant
<i>Coprosma</i> 'Karo Red'*	EG	1m (3ft)	white	spring	☼☉		8	Deep red-black foliage, great foliage shrub
<i>Cornus alba</i> 'Siberica'*	D	2m (6ft)	insignif.	spring	☼☉		2	Vivid red bark winter, great in winter container
<i>Cornus sanguinea</i> 'Midwinter Fire' *	D	2m (5-6ft)	yellow	fall col.	☼☉		2	Colourful stems in winter, red/orange/yellow
<i>Cornus walteri</i>	D	6m (20 ft)	white	spring	☼☉	yes	6	Rare. Corymbose flowers, reddish-purple berries

TREES AND SHRUBS

Plant Name	D/EG	Height	Colour	Bloom	Expos.	Frag	Z	Information
<i>Corokia</i> 'Little Prince'*	EG	1.5m (4ft)	yellow	spring	☼		8	Dwarf. Beautiful zigzag, grey twig and tiny leaf
<i>Corokia</i> 'Sun Splash'*	EG	1-2m (3-6ft)	yellow	spring	☼		8	Varieg. leaf golden sage, container, drought tolerant
<i>Corokia cotoneaster</i> *	EG	1-2m(3-6ft)	yellow	spring	☼		7-8	Grown for the beautiful zigzag grey twigs
<i>Corylopsis pauciflora</i> *	D	2m (4-6ft)	p. yellow	wint-spr	☼☉	yes	6	Cowslip scented, slow grower
<i>Cotinus coggygia</i> 'Grace'	D	5m (15ft)	deep pink	June	☼		5	Intense wine red leaf, fall colour bright orange red
<i>Cotinus coggygia</i> 'Pink Champagne'	D	2-3m (6-8ft)	pink	June	☼		5	New growth bronze-purple, green summer, feathery flw
<i>Cotoneaster</i> 'Streibs Findling'*	EG	15cm (6 inch)	white	June	☼		5	Dark bluish foliage, red berries, lowest cotoneaster
<i>Cryptomeria japonica</i> 'Rasen' *	Con	6-15m (20-40ft)			☼☉		6a	Cord-like twisting foliage, container
<i>Cryptomeria japonica</i> 'Sekkan Sugi' *	Con	3-10m (10-30ft)			☼☉		6a	Slow growth, 10 ft in 10 years. Yellow foliage
<i>Cryptomeria japonica</i> 'Spiraliter Falcata' *	con	1-2m (3-6ft)			☼☉		6a	Interesting twisted, thin narrow leaves that spiral
<i>Cyclobalanopsis glauca</i> (syn <i>Quercus glauca</i>)	EG	8-10m(20-30ft)	acorns	fall	☼☉		7?	Evergreen oak, very small acorns, sheltered site
<i>Daphne</i> x 'Lawrence Crocker'		10cm (3-12in)	pink	spring	☼	Yes	6a	Alpine, good for rockery
<i>Davidia involucrata</i> (dove tree)	D	12m (40ft)	white	spring	☼☉	yes	6	Flowers resemble doves in flight. Textured bark
<i>Deutzia gracilis</i> 'Pink Pom Pom' (syn. <i>D. x</i> hybrid 'Pink Pompom') *	D	1-1.5m (3-5ft)	pink	spring	☼☉		6	Double pink, burgundy leaf in fall. Long floral display
<i>Deutzia gracilis</i> 'Rosea' *	D	1m (3ft)	white	spring	☼☉		6	Pink buds open white, low arching, can take damp
<i>Deuzia x hybrida</i> 'Strawberry Fields' *	D	1.5m (5ft)	crimson	spring	☼☉	yes	7	Deep crimson outer petal, pink inner, containers
<i>Disanthus cercidifolius</i> *	D	3m (8-10ft)	red	fall	☉	yes	5	Witch hazel family, good fall colour in shade
<i>Distylium racemosum</i> (evergreen witchhazel) *	EG	3 m (10ft)	red	winter	☼☉		6-8	Interesting red spidery flower in leaf axials
<i>Edgeworthia chrysantha</i> 'Akebono'*	D	2m (5-6ft)	orange	winter	☼☉	yes	7a?	Orange tubular flower, protected site
<i>Elaeocarpus sylvestris</i>	EG	10m (40ft)	white		☼☉	yes	8b?	Small greeny-white fringed flowers in racemes. Frag
<i>Enkianthus</i> 'Bruce Briggs' *	D	1.5m (5ft)	red	spring	☼☉		5	Darkest red enkianthus, great fall colour
<i>Enkianthus campanulatus</i> *	D	1-2m (3-6ft)	cream	spring	☼☉		5	Upright shrub, pretty bell-shaped flowers, slow grower
<i>Erica carnea</i> 'Robert Jan' *	EG	10-15cm (6 in)	heliotrope	winter	☼		5	Heliotrope, Feb-March, trailing habit
<i>Erica carnea</i> 'Springwood Pink' *	EG	15-30cm(6-12)	pink	winter	☼		5	Clear pink, Jan-March, med moist, well drained soil
<i>Erica cinerea</i> 'Celebration' *	EG	20cm (8 inc)	white	summer	☼		7	Gold foliage in summer, lime in winter
<i>Erica x darleyensis</i> 'Furzey' *	EG	40cm (15in)	mauve	winter	☼		6	Pink tips to new growth in spring, Nov-May
<i>Erica x darleyensis</i> 'Ghost Hills' *	EG	26-30cm(1 ft)	heliotrope	winter	☼		6	Pink to heliotrope, Nov-May, new shoots cream tips
<i>Erica x darleyensis</i> 'J.H.Brummage' *	EG	30cm (12 inc)	red/purple	winter	☼		6	Foliage with yellow-orange tips. Bloom Jan -May
<i>Erica x darleyensis</i> 'Kramers Red' *	EG	43cm(16 inc)	violet	winter	☼		6	Compact and upright habit, Dec-April; (VD eval 2003)
<i>Eucommia ulmoides</i> (hardy rubber tree)	D	12m (40ft)	green	spring	☼☉		5	Thick leaves, pyramidal, medicinal.Resists pest/disease
<i>Euonymus alatus</i> 'Compactus' *	D	1.5m (5ft)	insignif.		☼		3	Brilliant red fall colour. Corky wings catch snow
<i>Euonymus hamiltonianus</i> ssp. <i>sieboldianus</i>	D	4m (12ft)	white	sum	☼☉		4	Fruit 4 lobed, pink calyx around orange seed in fall
<i>Euryops pectinatus</i> 'Munchkin' *	EG	.5-1m (1.5-3ft)	yellow	summer	☼		8	-12C, dwarf, slow, long bloom, grey blue ferny foliage
<i>Euryops pectinatus</i> 'Viridis' *	EG	1-1.5m (3-5ft)	yellow	summer	☼		8	South African native, rocky slopes, green ferny foliage
<i>Forsythia koreana</i> 'Kumson' *	D	1.25-2m (4-6ft)	yellow	spring	☼☉		4	Beautiful variegated netting on leaf
<i>Fothergilla gardenii</i> *	D	1-2m(3-5ft)	cream	spring	☼☉	yes	5	Upright habit, great fall colour, orange/red/purple
<i>Franklinia alamahama</i>	D	6m (20ft)	white	fall	☼☉	yes	8	Seed grown. Rare beauty. Vivid fall colour

TREES AND SHRUBS

Plant Name	D/EG	Height	Colour	Bloom	Expos.	Frag	Z	Information
<i>Fuchsia</i> 'Erecta Novelty' *	D	1-2m (3-6ft)	white purp	summer	☼○		7a	White sepals/pink corolla, single. Attracts hummers
<i>Fuchsia</i> 'Lottie Hobbie' *	D	.5-1m(1.5-3ft)	pink	summer	☼○		7a?	Small, delicate pink fuchsia flower, protected site
<i>Fuchsia regia</i> *	D	1.5m (5ft)	pink/pur	summer	☼○		8a	Longer linear leaf, twining tendency, long narrow flw
<i>Ginkgo biloba</i> *	D	12m (36ft)		spring	☼		4	Whale-tail lobed leaves. Yellow fall colour
<i>Gymnocladus dioicus</i> (Kentucky coffee tree)	D	12m (40ft)	white	spring	☼○		4	Bi-pinnate leaves, pointy leaflets, pest free
<i>Hebe buchananii</i> *	EG	18-30cm(8-12i	white	summer	☼		7a	Dwarf, blue-green foliage,
<i>Hebe cupressoides</i> 'McKean' *	EG	30cm(12inc)	white	summer	☼		7a?	Mound growing, small leaf, alpine /rock garden
<i>Hebe odora</i> (syn <i>H. buxifolia</i>) *	EG	1-1.2m (3-4ft)	white	summer	☼		7a	Compact upright, bright green leaf, yellow edge
<i>Hibiscus syriacus</i> 'Blue Bird' (rose of Sharon) *	D	4m (12ft)	blue	sum-fall	☼		5	Single, large sky-blue flowers with red eye
<i>Hibiscus syriacus</i> 'Mathilde' *(syn 'Blush Satin')	D	3-4m (8-12ft)	rose pink	summer	☼		5	Soft pink with deep pink eye, single flower
<i>Hibiscus syriacus</i> 'Minerva' *	D	3-4m (8-12 ft)	mauve	summer	☼		5	Single mauve flower with reddish centre
<i>Hibiscus syriacus</i> 'Red Heart' *	D	3-4m (8-12ft)	pale pink	summer	☼		5	Pink flower with deep maroon eye, late to leaf out
<i>Huodendron tibeticum</i> *	EG	5-10m(15-30f)	white	spring	☼○		8a?	Styrax family member, needs protection,
<i>Hydrangea macrophylla</i> 'Forever Pink' *	D	1m (3ft)	pink	summer	☼○		5	Pink mop head, semi dwarf, 2 months of bloom
<i>Hydrangea macrophylla</i> 'Freedom' *	D	.75-1m(2-3ft)	pink	summer	☼○		5	Double waterlily-like blooms, pink/white edged, comp
<i>Hydrangea macrophylla</i> 'Libelle' *	D	2m (6ft)	white	summer	☼○		5	White lacecap
<i>Hydrangea macrophylla</i> 'Merritts Beauty' *	D	1.5m (5ft)	blue	summer	☼○		6	Mophead, true blue in PNW acidic soils
<i>Hydrangea macrophylla</i> 'Nikko Blue' *	D	1-3m (3-9ft)	blue	summer	○		5	Old cultivar, good bloomer in shade
<i>Hydrangea macrophylla</i> 'Pia' (syn Pink Elf)*	D	1m (3ft)	rich pink	summer	☼○		5	Dwarf globuse flower, compact slow
<i>Hydrangea macrophylla</i> 'Selina' *	D	1m (3ft)	pink	summer	☼○		5	Pink to mauve lacecap, maroon foliage
<i>Hydrangea macrophylla</i> 'Thunbergii' (syn <i>H. serrata</i> 'Thunbergii') *	D	1.5m (5ft)	white /blue	summer	☼○		5	Lace cap, white sepals, purple/pink inner
<i>Hydrangea paniculata</i> 'Grandiflora'	D	3-6m (10-20ft)	cream	sum-fall	☼○		3	Conical head, loose sterile flowers
<i>Hydrangea serrata</i> 'Beni Gaku' *	D	1.5m (5ft)	pink	summer	☼○		6	Lace cap, tricolour, flowers emerge white, darken to pink with red edges.Small fertile florets are dark purple
<i>Illicium floridanum</i> 'Woodlanders Ruby' *	EG	2-3m (6-10ft)	ruby	summer	○		7?	Red starfish-like, waxy flower
<i>Illicium henryi</i>	EG	2-4m(7-12ft)	red	summer	☼○		7	Red waxy bell-shaped flower, glossy green foliage
<i>Juglans ailantifolia</i> var. <i>cordiformis</i> (CW 1' Heartnut)	D	12m (36ft)	white	spring	☼		5	Sweet heart-shaped kernels; mild; buttery,150nuts/kg 8-20 nuts/cluster. Very productive, choice
<i>Juglans cinerea</i> (butternut)	D	20m (60ft)	white	spring	☼		4-9	Sweet edible nuts. Self fertile
<i>Juglans nigra</i> (black walnut)	D	20m (60ft)	white	spring	☼		4-9	Sweet edible nuts. Valuable timber. Self fertile
<i>Kalmia latifolia</i> 'Peppermint' *	EG	1.5m(5ft)	red/white	spring	☼○		4	Banded red and white flower
<i>Lavandula angustifolia</i> 'Hidcote Superior' *	EG	35-50cm(15-18in)	violet blue	spr-fall	☼	yes	5	Deep violet-blue, improvement over Hidcote, needs good drainage
<i>Lavandula angustifolia</i> 'Munstead' *	EG	.5m (1-11/2ft)	purple	spr-Fall	☼	yes	5	Compact, lighter colour, longer bloom
<i>Lavandula stoechas</i> 'Silver Anouk' *	EG	25-35(10-14in)	purple	spr-fall	☼	yes	7	Spanish or butterfly lavender, grey foliage
<i>Lavandula x intermedia</i> 'Grosso' *	EG	30-60cm(1-2ft)	purple	spr-fall	☼	yes	6?	Most fragrant of lavenders, silver green foliage
<i>Lavandula x intermedia</i> 'Provence' *	EG	30-60cm(1-2ft)	purple	spr-fall	☼	yes	6?	Roots are hardy if dieback, long flower spike for weave
<i>Lavatera</i> 'Baby Barnsley' *	D	1m (3ft)	pink	summer	☼		7	Subshrub, long bloom period, drought, pink-tinge white

TREES AND SHRUBS

Plant Name	D/EG	Height	Colour	Bloom	Expos.	Frag	Z	Information
<i>Lavatera</i> 'Olbia Rosea'* (syn. <i>L. x clementii</i> 'Rosea')	D	1-2m(3-6 ft)	pink	summer	☼		7	Subshrub, maple shaped grey-green leaves,
<i>Lavatera</i> 'Red Rum' (<i>L. x clementii</i> 'Red Rum') *	D	1-1.2m(3-4ft)	red/pink	summer	☼		7	Deep pink to near red, long bloom period, semi dwarf
<i>Leptospermum lanigerum</i>	EG	3m (10ft)	white	spr/sum	☼	leaf	8?	Woolly tea tree, ideal drainage, protected site
<i>Leptospermum scoparium</i> 'Red Damask'	EG	3m (10ft)	dark red	spr/sum	☼	leaf	8?	Deep double red flowers, ideal drainage, protected site
<i>Leucothoe axillaris</i> *	EG	1.2m (2-4ft)	white	spring	☼☉	yes	6	Slow grower, low, leaves bronze/purple winter
<i>Leucothoe fontanesiana</i> 'Rainbow'	EG	1.5m (5ft)	cream	spring	☼☉		5	Dry shade. Foliage, marbled cream, pink, green
<i>Leucothoe fontanesiana</i> 'Scarletta' *	EG	60cm (2ft)	cream	spring	☼☉		5	Dry shade, foliage bright red-green-deep red
<i>Leycesteria formosa</i> (Himalayan honeysuckle)	D	2m (6ft)	white	sum-fall	☼☉		7	Fast growing, purplish racemes
<i>Liriodendron tulipifera</i> (tulip tree)	D	30m (90ft)	yellow	summer	☼☉	yes	5-9	Unique lobed leaves
<i>Lonicera nitida</i> 'Lemon Beauty' *	EG	1-2m (3-6ft)	cream	summer	☼☉		6?	Golden edge to leaf, tiny delicate, dry shade
<i>Lonicera pileata</i> 'May Green' *	EG	1.5m(4ft)	cream	summer	☼☉		6?	Small leaf, green, dry shade
<i>Magnolia</i> 'Blushing Belle'	EG	5-6m(15-20ft)	pink	spring	☼☉		5	Blush pink, narrow tepals
<i>Magnolia</i> 'Galaxy' (<i>kosar</i> hybrid) *	D	10m (30ft)	red-purple	m.sprng	☼☉	yes	5	Narrow conical. Flowers young, deep red-purple buds open to lighter red-purple outside, pale rose inside
<i>Magnolia</i> 'YellowBird'	D	6-12(20-40ft)	yellow	spring	☼☉	yes	5	Deepest yellow of the yellow mags, upright pyramid
<i>Magnolia grandiflora</i> 'D.D. Blanshard' *	EG	10m (30ft)	cream	summer	☼☉	yes	6	Leaf rusty-brown indumentum, blooms at 2 yrs old
<i>Magnolia kobus</i> var. <i>borealis</i>	D	10m (30ft)	white	winter	☼☉	yes	4	Very early, white & pink flowers; sinuous, broad shape
<i>Magnolia kobus</i> var. <i>kobus</i>	D	7m (21ft)	white	spring	☼☉	yes	5	Pyramidal form
<i>Magnolia lotungensis</i>	EG	10m (30ft)	ivory	summer	☼☉	yes	7	Rare. Upright from, used as street tree
<i>Mespilus germanica</i> 'Breda Giant' (medlar) *	D	5-7m(15-20ft)	white/pink	spring	☼☉		5	Small tree, apple-like blossom, edible fruit once bletted
<i>Michelia platypetala</i> (syn. <i>Magnolia cavaleri</i> var. <i>platypetala</i>)	EG	6-10m(20-30ft)	white	spring	☼☉	yes	7	Very fragrant, white auxiliary blooming, blue-green foliage. VanDusen has one along the Rhodo Walk
<i>Michelia yunnanensis</i> (syn. <i>Magnolia lavefolia</i>) *	EG	4 m (18ft)	white	spring	☼☉	yes	7/8	Slow grower, brown indumentum leaves and buds
<i>Nandina domestica</i> 'Gulf Stream' *	EG	1m (3ft)	cream	spr/sum	☼☉	yes	7	Busy compact, new growth bronze with orange tints
<i>Nandina domestica</i> 'Harbour Dwarf' *	EG	1m (2-3ft)	cream	spr/sum	☼☉	yes	7	Dry shade, metallic-blue foliage, red-tinged winter fol
<i>Nandina domestica</i> 'Moon Bay' *	EG	1m (2-3ft)	cream	spr/sum	☼☉	yes	7	Lighter green leaf, bright red in winter, dry shade
<i>Nandina domestica</i> *	EG	1-3m (3-9ft)	cream	spr/sum	☼☉		7	Pinnate bamboo-like fol, red fruit if planted in group
<i>Nyssa sylvatica</i> 'Tupelo Tower'	D	12m (40ft)	yellow/or	fall	☼☉		4	Very tight upright habit, good for small gardens
<i>Osmanthus heterophyllus</i> 'Goshiki' *	EG	2m (6ft)	white	fall	☼☉	yes	6	Foliage mottled yellow/bronze when young
<i>Osmanthus heterophyllus</i> 'Variegatus' *	EG	2.5m (8ft)	white	fall	☼☉	yes	6	Leaf edged cream, drought tol when established, shade
<i>Paeonia rockii</i> hybrids (genus peony) *	D	2m (6ft)	white	spring	☼☉	yes		White to pink to magenta, with dark purple blotch
<i>Paeonia suffruticosa</i> 'Hanakisoi' (syn. 'FloralRivaly')	D	1-1.75m(to5ft)	pink	spring	☼☉	yes	5	Semi-double, apricot/shell-pink, yellow stamens
<i>Paeonia suffruticosa</i> 'High Noon' *	D	1.5m (60 in)	yellow	spring	☼☉	yes	5	Clear yellow, semi double, fragrant
<i>Paeonia suffruticosa</i> 'Kamatanishiki' * (syn. 'Kamata Tapestries')	D	1.5m (4-5ft)	mauve	spring	☼☉		5	Semi-double, wisteria-blue fading at the edges
<i>Paeonia suffruticosa</i> 'Kao' *	D	1.5 m (60 in)	pink/red	spring	☼☉	yes	5	Lemon-scented, double pinky/red
<i>Paeonia suffruticosa</i> 'Kinkaku' * (syn. 'Golden Temple of Nara')	D	1.5m (4-5 ft)	yellow	spring	☼☉	yes	5	Multitude of yellow petals edged in bright orange, fill the fully double blooms

TREES AND SHRUBS

Plant Name	D/EG	Height	Colour	Bloom	Expos.	Frag	Z	Information
<i>Paeonia suffruticosa</i> 'Renkaku' *	D	1.7m (3-4ft)	white	spring	☼○		5	'Renkaku' translates "flight of the cranes". Very large, semi-double, white-fringed petals with orange stamens
<i>Paeonia suffruticosa</i> 'Shima Nishiki' * (syn. 'Fire Flame')	D	1m (3ft)	red/white	spring	☼○		5	Two toned striped with rose-red and white, semi double variety, yellow stamens
<i>Paeonia suffruticosa</i> 'Shimadaijin' *	D	1.5m (3-5ft)	magenta	spring	☼○		5	Rare, Imperial peony from Japan, translates to "Island Minister". Large, double, rich magenta bloom
<i>Penstemon</i> 'Garnet' *	D	.25-.5m(1-2ft)	garnet	summer	☼		7a	Subshrub, long bloom period, hummers and butterflies
<i>Penstemon</i> 'Red Rocks'	D	50cm (18 inc)	rose red	summer	☼		6a?	Subshrub, rose red pink/white, drought, dry site
<i>Philadelphus</i> 'Galahad'*	D	1-1.5m(3-5ft)	white	spring	☼○	yes	3	Single white, compact shrub, rounded silhouette
<i>Philadelphus x lemoinei</i> 'Manteau D'Hermine' *	D	1-1.5m (2-4ft)	cream	spring	☼○	yes	5	Double cream, very fragrant, arching shoots, dwarf
<i>Philadelphus x virginalis</i> 'Minnesota Snowflake' *	D	1-2m (3-6ft)	white	spring	☼○	yes	5	Compact, double flower on old wood, prune after flw
<i>Phormium tenax</i> *	EG	.2-2m(1-6ft)	red	late sum	☼○		7	Spiky upright thick grass looking agave family member
<i>Phygelius x rectus</i> 'Pink Elf' *	D	.75m (2ft)	pink	summer	☼		7a	Subshrub. Compact dwarf, dusty pink, red throat
<i>Physocarpus opulifolius</i> 'Centre Glow' *	D	2-2.5m (6-8ft)	white/pink	summer	☼○		7a	Great foliage, gold/orange/green/copper, red seed heads
<i>Physocarpus opulifolius</i> 'Coppertina' *	D	2-2.5m (6-8ft)	white/pink	summer	☼○		2	Copper orange new growth in summer changes to rich red-burgundy. Compact growth, difficult situations
<i>Physocarpus opulifolius</i> 'Diablo'	D	2-3.5m (-10ft)	white	summer	☼○		2	Intense red-purple leaf, low maintenance
<i>Pieris japonica</i> 'Brookside Miniature'*	EG	45cm (18inc)	pink/white	spring	☼☼	yes	6	Compact, columnar growth, arching flower panicle
<i>Pieris japonica</i> 'Katsura' *	EG	1m (3ft)	pink/white	spring	☼☼	yes	6	Deep burgundy-red new growth
<i>Pieris japonica</i> 'Mountain Fire' *	EG	2-3m (6-8ft)	white	spring	☼☼	yes	6	Heavy flower clusters, bright red new growth changes to copper red. All Pieris are good for mason bees
<i>Pieris japonica</i> 'Sarabande' *	EG	1m (3ft)	pink/white	spring	☼☼	yes	6	Compact, pink bud, white flwr, new growth orange/red
<i>Pieris japonica</i> 'Valley Rose' *	EG	1.5m (5ft)	rose-pink	spring	☼☼	yes	6	Deep rose-pink cap fades to blush at tip of flower. Two-toned flowers. Slow grower, bronze new growth
<i>Pieris japonica</i> 'Valley Valentine' *	EG	1-1.75m(3-5ft)	red	spring	☼○	yes	6	Dark red bud, flower red/dark pink hardly fading
<i>Pinus koraiensis</i> (Korean pine nut)	EG	+7m (21ft)		spring	☼○			Most pine nuts come from this species. Self fertile
<i>Potentilla fruticosa</i> 'Abbotswood' *	D	1m (2-3ft)	white	summer	☼		3	Best white flower, bluish-green leaf, drought tolerant
<i>Potentilla fruticosa</i> 'Katherine Dykes' *	D	1m (2-3ft)	yellow	summer	☼		3	Primrose-yellow, silver foliage, drought, no wet soils
<i>Potentilla fruticosa</i> 'Pink Beauty' *	D	1m (3ft)	mid pink	spr-fall	☼		2	Semi-double flower, compact, drought tolerant
<i>Prostanthera cuneata</i> *	EG	.46m (1.5 ft)	white	spr/sum	☼○	fol	7b	Well drained, refreshing minty frag when brush leaves
<i>Prunus davidiana</i> (wild Chinese peach)	D	8m (26 ft)		spring	☼		4-9	Medicinal, inedible fruit, disease free
<i>Pterostyrax corymbosa</i>	D	5-10m(15-30ft)	white	summer	☼○	yes	6	Styrax family, drooping panicle flower, decorative winged fruit, very delicate appearance
<i>Raphiolepis umbellata</i> 'Minor'	EG	1.2m(3-4ft)	white	spr/sum	☼	yes	7b?	Dwarf. Foliage emerges grey-green matures to glossy green, maroon in winter; slow grower.
<i>Rhodotypos scandens</i> *	D	1-2m (3-5ft)	white	spring	☼○		5	Arching shoots, 4 petal flower, jet-black berry
<i>Rosa</i> 'Country Dancer'	D	1.5m (5ft)	pink	summer	☼	yes	3	Semi-double, rosy-red, long bloom season,
<i>Rosa</i> 'David Thompson' (explorer series)	D	1m (3.5 ft)	crimson	summer	☼	yes	3	Semi-double, textured leaf, nearly thornless, long seas
<i>Rosa</i> 'John Franklin' (explorer series)	D	1-1.2m (3-4ft)	red	summer	☼	yes	3	Double, fringed like carnations, clusters, long season

TREES AND SHRUBS

Plant Name	D/EG	Height	Colour	Bloom	Expos.	Frag	Z	Information
<i>Rosa</i> 'Lambert Clossure' (explorer series)	D	1m (2-3ft)	pink	summer	☼	yes	2	Silvery-pink resembles hybrid teas, repeat bloomer
<i>Rosa</i> 'Morden Amoretti' (parkland rose)	D	.75m(2ft)	red/pink	summer	☼	ligh	2b	Compact, continual, semi-double, petals curl inward
<i>Rosa</i> 'Prairie Princess'	D	1.5m (5ft)	pink	summer	☼	yes	4a	Double pink, repeat bloomer, bushy upright
<i>Rosa meidiland</i> 'Carefree Delight'	D	1.2-2m (4-6ft)	carmine	summer	☼	ligh	4	Single carmine pink with white eye, continual, red hips
<i>Rosa meidiland</i> 'Fuchsia'	D	1m (3ft)	deep pink	summer	☼	ligh	5b	Semi-double, continual,
<i>Rosa meidiland</i> 'Red'	D	.75-1m (2-3ft)	red	summer	☼		4	Single red with white centre, continual, orange hips
<i>Rosa rugosa</i> 'Alba'	D	1.3-2m (4-6ft)	white	summer	☼	yes	2	Pure white single, repeats, large orange hips
<i>Rosa rugosa</i> 'Belle Potevine'	D	1.3m (4 ft)	pink	summer	☼	yes	4	Semi-double, continual, orange red hips,
<i>Rosa rugosa</i> 'Darts Dash'	D	1-1.3m (3-4ft)	mauve red	summer	☼	yes	4	Semi-double, sweet scent, repeat, large orange/red hips
<i>Rose</i> 'Reine Des Violettes'	D	1m (3ft)	red	summer	☼	yes	5	1860's French hybrid perpetual, own root, repeat
<i>Salix integra</i> 'Hakuro Nishiki'*	D	1.5m (5ft)	foliage		☼○		6	Light green, blotched white foliage, wispy growth
<i>Salix magnifica</i>	D	2.5-4m (7-14ft)	yellow	spring	☼○		7	Large magnolia like foliage, very large up facing catkin
<i>Salix purpurea</i> 'Nana'*	D	1-1.4m (3-5ft)	white	spring	☼		4	Compact, rounded shrub, blue-green leaves,
<i>Salix</i> x 'Scarlet Curls'*	D	7-9m (25-30ft)		spring	☼○		4	Contorted, non invasive, used in floral displays, red twigs, small oval tree, patio container
<i>Sambucus nigra</i>	D	4-6 m (8-20ft)	white	spring	☼○	yes	5	Medicinal multi-stemmed shrub, delicious black fruit
<i>Sarcococca hookeriana</i> var. <i>humilis</i> (sweet box) *	EG	45cm (18in)	cream	winter	●	yes	6	Mounding, dwarf shrub, black berries
<i>Sarcococca ruscifolia</i> (sweet box) *	EG	1.2m (3-4ft)	cream	winter	●	yes	8-9	Slow grower, dry shade. Violet frag. Red to black fruit
<i>Sassafras albidum</i>	D	5m (15ft)	yellow	spring	☼○	yes	5	Rare, once flavoured rootbeer. Fine powder in Creole
<i>Skimmia japonica</i> 'Chameleon' (Female) *	EG	1m (3ft)	white	winter	●○	yes	7	Female. Red, white and green berry
<i>Skimmia japonica</i> 'Dwarf Male' *	EG	1m (3ft)	white	winter	●○	yes	7	Male, red bud in winter, white flower, very fragrant
<i>Skimmia japonica</i> 'Fragrant Cloud' (male)*	EG	1m (3ft)	white	winter	●○	yes	7	White flower open from lime-green bud, slow grower
<i>Skimmia japonica</i> 'Luwian' (male) *	EG	1m (3ft)	cream	Early spr	●○	yes	7	Small mounding, very frag, reddish brown buds in fall then red in winter, then blooms early spring, male
<i>Skimmia japonica</i> 'Olympic Flame' (female)*	EG	1m (3ft)	white	winter	●○	yes	7	Flame red buds in fall, white flower spring, berries
<i>Skimmia japonica</i> 'Red Princess' (female)*	EG	1 m (3ft)	white	winter	●○	yes	7	Red buds in winter. Dry shade, all skimmias
<i>Skimmia japonica</i> 'Rubella' *	EG	1m (3ft)	cream	winter	●○	yes	7	Red buds in fall, white in spring, male
<i>Spirea betulifolia</i>	D	1m (2-3ft)	white	May-Jul	☼○		5	dwarf, dense mound, foliage blue-green
<i>Spirea japonica</i> 'Little Princess' *	D	.75m (2ft)	pink	summer	☼○		5	Mounded habit, dwarf shrub, pale pink flw; butterflies
<i>Spirea japonica</i> 'Magic Carpet' *	D	.6m(18-24in)	pink	summer	☼○		5	Compact, reddish-bronze new leaf, chartreuse-yellow
<i>Spirea japonica</i> 'Shirobana' *	D	1m (3ft)	pink-red	summer	☼○		5	Pink, red, white flwrs at same time, blue-green foliage
<i>Spirea nipponica</i> 'Snowmound' *	D	.7-1.3m (2-4ft)	white	summer	☼○		3	Arching branches, waterfall effect, blue-green foliage
<i>Spirea</i> x <i>bumalda</i> 'Darts Red' *	D	1m (2-3ft)	carmine	summer	☼○		4	Compact, long lasting carmine-red flw, purple fall
<i>Syringa</i> 'Tinkerbelle' *	D	2m (5-6ft)	wine	spring	☼	yes	3	Wine buds open to pink flowers, spicy frag, dwarf
<i>Syringa meyeri palibin</i> (dwarf Korean lilac) *	D	2m (4-5ft)	lav-pink	spring	☼○	yes	5	Reddish-purple bud opens to pale pink, dwarf spicy fragrance. Smaller leaf than 'Miss Kim'. Slow grower
<i>Syringa pubescens</i> ssp. <i>patula</i> 'Miss Kim' (lilac) *	D	2.7m (4-9ft)	purple	spring	☼○	yes	5	Small, slow growing, Korean lilac. Floriferous
<i>Syringa reflexa</i> (nodding lilac)	D	4m (12ft)	pink	summer	☼○		5	Wisteria-like flower cluster, arching multi stem
<i>Syringa vulgaris</i> 'Aucubaefolia'	D	3m (9ft)	blue	spring	☼○	yes	3a	Variegated leaf splashed with gold, double blue flower

TREES AND SHRUBS

Plant Name	D/EG	Height	Colour	Bloom	Expos.	Frag	Z	Information
<i>Syringa vulgaris</i> 'Beauty of Moscow'	D	5m (15ft)	cream	spring	☼	yes	5	Pink buds, cream flower, dry conditions ok, strong frag
<i>Syringa vulgaris</i> 'Charles Joly'	D	3-3.7m (10-12f)	purple	spring	☼	yes	5	Double purple, Lemoine hybrid, fantastic fragrance
<i>Syringa vulgaris</i> 'Colby's Wishing Star' *	D	1-1.5m(3-4ft)	pink	spring	☼○	yes	4	Dwarf lilac, if deadheaded will rebloom in summer/fall
<i>Syringa vulgaris</i> 'Monge'	D	2-4m(6-12ft)	dp. purple	spring	☼	yes	5	Bright purple, sweet fragrance; Lemoine hybrid
<i>Syringa vulgaris</i> 'President Grevy'	D	4m (12ft)	lavender	spring	☼	yes	5	Highly fragrant, double light blue
<i>Syringa vulgaris</i> 'Sensation'	D	2-4m (6-12ft)	purple/wh	spring	☼	yes	5	Purple edged in white, lighter in fragrance
<i>Syringa vulgaris</i> 'Wonderblue' syn.'Little Boy Blue'	D	1.2-1.5m(4-5ft)	Sky blue	spring	☼	yes	4	Single, slower growing, compact
<i>Syringa x laciniata</i>	D	2-3m (6-10ft)	lavender	spring	☼○	yes	4a	Lace leaf, deeply cut, single, pale lavender flower
<i>Syringa x prestoniae</i> 'Red Wine'	D	2-3m (6-8ft)	magenta	summer	☼	yes	2	Blooms 2 weeks after <i>S. vulgaris</i> , spicy frag, single flw
<i>Viburnum carlesii</i> *	D	1-2m (4-6ft)	pink/white	spring	☼○	yes	4	Red fall colour, tolerates adverse cond. Slow grower
<i>Viburnum sargentii</i> 'Onondaga'	D	2-2.75m(6-8ft)	white	spr/sum	☼○		3a	Lace-cap flower, pink buds, Maroon hue to leaf, fall colour, red, very good, bright red berries
<i>Viburnum tinus</i> 'Spirit' *	EG	1.5-2m(4-6ft)	white	spring	☼○		7a	Pink buds in winter, white flw spring, blue black fruit
<i>Viburnum x bodnatense</i> 'Dawn'	D	2.5-3m (-10ft)	pink	winter	☼○	yes	7	Vase-shaped, tubular flower, blooms in mild 'snaps'
<i>Viburnum x carlcephalum</i> (Fragrant snowball)	D	2-3m (6-10ft)	white	spring	☼○	yes	6	Dense white flowers in dense snowball like clusters, carnation clover fragrance, foliage red/purple in fall
<i>Weigela florida</i> 'Nana Variegata' *	D	1m (3ft)	pale pink	spring	☼○		5	White-edged leaves, rounded form, pink/pale pink/white flowers, compact
<i>Weigela florida</i> 'Rosea'	D	2m (6-7ft)	pink	spring	☼○		5	Arching growth, pink bellflower. Attracts hummers
<i>Weigela florida</i> 'Rumba' *	D	1.2m (3-4ft)	Red/yellow	spring	☼		5	Compact, wine red yellow throat flw. Purple-edged yellow-green foliage. Attracts butterflies & hummers
<i>Weigela middendorffiana</i>	D	1-2m (3-5f)	yellow	spring	☼○		5	Yellow tubular flower with orange throat. Rare
<i>Yucca dismetiana</i> 'Blue Boy' *	EG	1-2m(4-6ft)	white	summer	☼		8?	Stalked yucca, purple leaves, heat and drought, protect
<i>Yucca filamentosa</i> 'Colour Guard' *	EG	1 m (3ft)	white	summer	☼	yes	5	Apricot winter colour, central leaf yellow, brightens to golden in summer. Tall candelabra flower, drought
<i>Yucca filamentosa</i> 'Golden Sword' *	EG	1.2m (4ft)	white	summer	☼	yes	5	Gold centre variegation, leaves not quite as stiff as 'Colour Guard'
<i>Yucca glauca</i> *	EG	1.2m (4ft)	white	summer	☼	yes	7	This one native to plains. Grey-blue leaves, often frag flower, night-pollinated, architectural plant

The following symbols are used: Sun=☼ Part shade=☼○ Shade=● * Denotes that tree or shrub is suitable for small gardens or for planting in pots.

Henry Eddie, a renowned BC horticulturist, developed '**Eddie's White Wonder**', a hybrid dogwood tree in the 1930s and 1940s. It is a cross between the western flowering dogwood, *Cornus nuttallii*, which has a white to pinkish bracts (not petals) and the eastern dogwood, *Cornus florida*, which can have deeper pink bracts. '**Eddie's White Wonder**' is of narrow form with layered branches typical of tree dogwoods and white flowers (bracts). It was bred to be more resistant to the fungal disease, anthracnose, than the native dogwood.

VINES

Plant Name	Height	Colour	Bloom	Expos.	Information
<i>Clematis</i> 'Allanah'	2-4m (6-8ft)	rosy pink	May/June&Sept	sun/shade	Pruning Gr B1. Compact variety, good for pots and shade
<i>C.</i> 'Asao'	2-3m (6-8ft)	mauve/red	April & May	sun/shade	Pruning Gr A. Bell-shaped flowers, attractive seed heads
<i>C. alpina</i> 'Willy'	2-2.5m (6-8ft)	mauve/pink	April & May	sun/shade	Pruning Gr A. Lovely spring colour
<i>C. armandii</i> 'Apple Blossom'	6-9m (20-30ft)	white/pink	March & April	sun	Pruning Gr A. Vigorous, evergreen, fragrant, frost-free spot
<i>C. armandii</i> 'Snowdrift'	6-9m (20-30ft)	white	March & April	sun	Pruning Gr A. Vigorous, evergreen, fragrant, frost-free spot
<i>C.</i> 'Bell of Woking'	2--3.5(6-9ft)	white	July to July	sun/shade	Pruning B1. Sunny spot, double flower
<i>C.</i> 'Blue Light'	2-2.5m (7ft)	blue	May, June & Sept	sun	Pruning Gr B2. Mauve-double flower. Good cutting
<i>C.</i> 'Comtesse de Bouchaud'	2-4m (8-12ft)	mauve-pink	June to Sept.	sun	Pruning Gr C. One of the most popular clematis ever grown
<i>C.</i> 'Crimson Star'	4-4m (8-12ft)	red	May-June & Sept	sun	Pruning Gr B2. Can tolerate some shade
<i>C.</i> 'Daniel Deronda'	2-2.5m (7-9ft)	purple-blue	May, June &Sept	sun	Pruning Gr B1. Cutting flower
<i>C.</i> 'Danielle' Vancouver Select Series	2-3m (6-8ft)	violet-blue	May, June &Sept	sun	Pruning Gr B1. Brilliant violet-blue. Containers
<i>C.</i> 'Duchess of Edinburgh'	2.5m (8ft)	double white	May, June &Sept	sun/shade	Pruning Gr B1. Cutting flower. Double white
<i>C.</i> 'Dorothy Walton'	2.5 (8-ft)	deep mauve	June to Sept.	sun	Pruning Gr C. Free flowering
<i>C.</i> 'Ernest Markham'	3-4m (8-12ft)	June to Sept.	June to Sept.	sun	Pruning Gr C. Rich colour, and good for cutting
<i>C.</i> 'Dr. Ruppel'	2.5-3m (8-12)	rose red	June to Sept.	sun	Pruning GrC. Will tolerate more shade
<i>C.</i> 'Etoile Violette'	3-4m (8-14)	purple	June to Sept.	sun	Pruning Gr.C. Free flowering all summer
<i>C.</i> 'Guiding Star'	3-4m (8-12)	deep purple	May to Sept.	sun/shade	Pruning Gr B2. Good for shade
<i>C.</i> 'Hagley Hybrid'	2-3m (6-9ft)	shell-pink	June to Sept.	sun/shade	Pruning Gr B2 or C. Small spaces or pots
<i>C.</i> 'John Warren'	2-3m(8-10)	white with pink	June to Sept.	sun/shade	Pruning Gr B2. Large flowers
<i>C.</i> 'Morning Mist' Vancouver Select Series	2-3m(6-8)	blush pink	June to Sept.	sun/shade	Pruning Gr B2. Frilled hot-pink edges on large blooms
<i>C.</i> 'Mrs. P. T. James'	3-4m(9-12)	sky blue	June to Sept.	sun/shade	Pruning Gr B1
<i>C.</i> 'Multi Blue'	3.5m (8-ft)	violet-blue	June to Sept.	sun	Pruning Gr B1. Will flower all summer
<i>C.</i> 'Romantica'	2-4m (8-12ft)	dark purple	July to Sept.	sun/	Pruning G rC. Good for cutting and pots
<i>C.</i> 'Ville de Lyon'	2-4m(8-12)	pink	May to October	sun	Pruning GR C or B
<i>C.</i> 'The President'	2-4m*8-12	deep purple	June to Sept.	sun	Pruning Gr B2
<i>C.</i> 'Fragrant Star' Vancouver Select Series	2-4m (8-12)	white	late spring	sun/shade	Pruning Gr B1/C. Vanilla scent
<i>C.</i> 'Westerplate'	2-3m(6-8ft)	crimson red	June to Sept.	sun/	Pruning Gr B2. Good for pots
<i>Campsis tagliabuana</i> 'Indian Summer'	climber	orange-red	summer	sun	Large trumpet-shaped flowers
<i>Campsis grandiflora</i>	10m (30ft)	orange-red	late summer-fall	sun	Very vigorous when established
<i>Hydrangea petiolaris</i> (climbing hydrangea)	15m (50ft)	creamy-white	summer	sun/shade	Suitable to grow up a tree or on a wall
<i>Jasminum officinale</i> (jasmine)	12m (40ft)	white	summer-fall	sun	Fragrant
<i>Jasminum polyanthum</i> (jasmine)	3m (10ft)	pink	spring-summer	sun	Fragrant
<i>Lonicera japonica</i> 'Halliana' (honeysuckle)	10m (30ft)	purple & white	spring-summer	sun or p/s	Fragrant Japanese variety, ages to yellow
<i>Passiflora caerulea</i> (blue passionflower)	10m (30ft)	purple,blue,white	summer bloom	sun	Striking blossom
<i>Schizophragma hydrangeoides</i> 'Rosa'	climber	assorted	summer	full sun	Prune to shape in spring. Good fall colour. Zone 5
RAYMOND EIVSON CLEMATIS	pot variety	lilac/purple/blue	summer	sun	Assorted varieties. Excellent for pots, walls, fences. Zone 5

Assorted Climbing Roses: Disease resistant, good for covering walls and fences – variety of colours.

Clematis Pruning: Gr. A – no pruning required; Gr.B – light pruning in early spring; Gr. C – Prune hard early spring.

TROPICALS

Plant Name	Height	Colour	Bloom	Zone	Information
<i>Actinidia deliciosa</i> (male & female kiwi vine)	5m (15ft)	white	summer	6	Fuzzy New Zealand kiwi vine. Canadian varieties
<i>Araucaria araucana</i> (monkey puzzle tree)	20m (slowly)			7	Ornamental, slow growing, Chilean evergreen tree
<i>Asimina triloba</i> (pawpaw) varieties: Mango, Davis, Mitchell, NC-1 Canadian, Overlease, Pennsylvania Gold	3.5m (10ft)			5-8	Mango-like sweet fruit. Hardy tree from East USA. Named varieties are good producers. For good pollination try 2 varieties
<i>Camellia sinensis</i> 'Sochi' hybrid (Chinese tea tree)	2.5m (7ft)	white	spring	8	The tea of commerce, green or black. Russian hybrid
<i>Camellia sinensis</i> (Korean tea tree)	2m (6ft)	white	summer	8	Commercial green tea in Korea. The Asian tea tree
<i>Citrus x aurantifolia</i> (bear's lime)	1m (3ft)	white	summer	9-11	Large limes, fragrant flower. Leaves used in cooking
<i>Citrus x aurantifolia</i> (Key lime)	1m (3ft)	white	summer	9-11	Small limes, fragrant flower. Limes used for cocktail drinks
<i>Citrus Cara Cara</i> (navel orange)	1-2m (3ft-6ft)	white		9-11	Commercial sweet, large, pink-fleshed orange from Venezuela
<i>Citrus Citrumelo</i> hybrid (hardy grapefruit)	1-2m (3ft-6ft)	white		8-10	Hardy small grapefruit, crossed with 'Flying Dragon'
<i>Citrus</i> 'Flying Dragon'	1-2m (3ft-6ft)	white		6	Hardest citrus in the world. Used for dwarf rootstock
<i>Citrus hystrix</i> (Thai or Kaffir lime)	1m (3ft)	white		9-11	Fragrant leaves used in Thai curries. Great fresh spice year-round
<i>Citrus junos</i> (Sudachi Ichandrin, hardy lemon)	1.5m (5ft)	white	fall	7	Super hardy lemon/lime citrus. Used for pickling and cooking
<i>Citrus junos</i> (Yuzu Ichandrin, hardy lemon)	1.5m (5ft)	white		7	Hardest, edible lemon tree. Good to - 16C
<i>Citrus kinokuni mukakukishu</i> (Kishu mandarin orange)	1-2m (3ft-6ft)	white		8-11	Small, sweet, seedless mandarin. Peels easily
<i>Citrus limettioides</i> (Palistine sweet lime, Indian sweet lime)	1m (3ft)	white		9-11	Large limes for the home grower
<i>Citrus limon</i> 'Meyer Lemon Improved'	2m (6ft)	white		(8) 9	Thin, yellow skin, mild, yellow flesh. Fragrant flowers
<i>Citrus microcarpa</i> (Variegated Calamondin)	1-2m (3ft-6ft)	white		9-11	Ornamental. Variegated foliage. Small mandarin kumquat cross
<i>Citrus</i> 'Nagami' (kumquat seedless)	1-2m (3ft-6ft)	white		9-11	Commercial kumquat
<i>Citrus sinensis</i> (Blood orange)	1-2m (3ft-6ft)	white		9-11	Large, sweet orange, blood-red orange
<i>Citrus sinensis</i> (variegated pink lemon)	1m (3ft)	white		9-11	Variegated plant. Lemons with pink juicy interior
<i>Diospyros virginiana</i> x (persimmon) Asian 'Nikita's Pride'	3m (9ft)	grn-yellow	1.spring	6-9	Sweet, ripen 1.fall. Asian-American hyb. Prairie Star', 'Meader'
<i>Eucomis Bicolor</i> (purple pineapple lily)	50cms (2ft)	maroon	summer	7-9	Rich maroon foliage. Flower and stalk resemble a pineapple
<i>Fargesia robusta</i> (Himalayan clumping mtn. bamboo)	5m (15ft)	bright grn		6	Fastest growing, tight-clumping bamboo
<i>Fargesia dracocephala</i> 'Rufa' (short clumping bamboo)	2m (6ft)			6	Dense, short, clumping bamboo, no maintenance
<i>Feijoa sellowiana</i> (pineapple guava)	2m (6ft)	red	summer	8	Red flowers and sweet edible fruit
<i>Ficus carica</i> 'Desert King' (fig)	4m (13ft)			7	Fast grower, produces large quantities of sweet green figs
<i>Microcitrus australasica</i> (finger lime)	1m (3ft)			9-11	Long tubular limes with caviar interior. Sweet, delicious. RARE
<i>Morus nigra</i> (Illinois ever-bearing mulberry)	5m (15ft)			6	Large, 1½" tasty, black fruit. Extremely prolific
<i>Musa maurelli</i> (red banana)	3m (9ft)			9-11	Large 5' red and green leaves. Creates a striking bold specimen
<i>Olea europaea</i> 'Arbequina' (olive tree)	2.5m (8ft)			8-11	Black olives, the olive tree of the Mediterranean
<i>Olea europaea</i> 'Sea Breeze', 'Universal' (olive tree)	2.5m (8ft)			8-11	Large fruit. Used for oil production.
<i>Persea americana</i> (avocado) 'Mexicola' & 'Lila'	2-3m (6ft-9ft)	yellow		8-11	Hardest of all avocados, producing tasty avocados in 2 years
<i>Phyllostachys nigra</i> (black bamboo)	6m (18ft)	black canes		6	Clumping black bamboo, the most popular variety
<i>Punica granatum</i> 'Wonderful', 'Favorite' (pomegranate)	2m (6ft)	orange-red	summer	8	Red flowers and fruit. Needs lots of heat
<i>Ugni molinae</i> (Chilean guava)	1m (3ft)	pale pink	summer	9-11	Small, sweet red guavas produced yearly on this bush guava
<i>Zanthoxylum simulans</i> (Szechuan Chinese pepper tree)	2m (6ft)	yellow-grn	summer	8	Spicy, multi-coloured peppercorns used in Asian cooking
<i>Ziziphus jujuba</i> (Chinese date) Vari.'Li', 'Lang', 'Coco', 'So'	2m (6ft)	yellow-grn		6-9	Small sweet fruit in fall. Loves dry heat. Cold hardy to -24C

SUCCULENTS AND CACTI

Plant Name	Height	Colour	Information
<i>Aeonium arboreum</i> 'Magnificum'	to 1m (3ft)	foliage	An impressive succulent with large spoon shaped pale green leaves
<i>Aeonium arboreum</i> 'Zwartkop' (black rose)	to 1m (3ft)	yellow	Long, bare stems hold large terminal rosettes of very dark, purple-black leaves
<i>Aeonium ciliatum</i>	to 1.5m (5ft)	foliage	Dr. Seuss like. Rare, true species forms a tall trunk topped by a foliar rosette
<i>Aeonium</i> 'Cyclops'	to 1m (3ft)	foliage	Beautiful tall succulent, with rosettes of dark reddish-bronze leaves on tall stems
<i>Aeonium haworthii</i> 'Kiwi'	30cm (12in)	foliage	Adds colour and texture with foliage of chartreuse, cream and red
<i>Aeonium</i> 'Sunburst' (copper pinwheel)	to 30cm (12in)	foliage	Large rosettes of variegated green and white leaves, edged in bright, coppery red
<i>Aeonium tabuliforme</i> (flat-topped aeonium)	10cm (4in)	foliage	Fleshy, hairy, bright-green leaves in flat rosettes, on short unbranched stems
<i>Aeonium undulatum</i> (saucer plant)	25cms (10in)	yellow	Terminal rosettes of fleshy, tongue-shaped, glossy leaves, tinged with red
<i>Agave Americana</i>	to 1.5m (5ft)	yellow	Handsome rosettes of spiny-edged, grey-green leaves. Misnamed 'century plant'
<i>Agave americana</i> 'Marginata'	to 1.5m (5ft)	foliage	One of the prettiest and most sought after variegated succulents. A living sculpture
<i>Aloe barbadensis</i> (<i>Aloe vera</i>)	45cm (18in)	orange/yellow	A succulent plant species found only in cultivation. Medicinal, cosmetic use
<i>Aloe brevifolia</i> (short-leaved aloe)	45cm (18in)	orange/red	Compact, blue-green aloe
<i>Aloe striata</i> (coral aloe)	40cm (16in)	coral	'Striata' refers to long lines on its blue-green leaves, and smooth pink margins
<i>Crassula capitella</i> 'Campfire' (campfire crassula)	15cm (6in)	foliage	Fleshy propeller-like leaves mature from light green to bright red. Fiery highlights
<i>Crassula capitella</i> ssp. <i>thyrsiflora</i> 'Pagoda Village'	25 cm 'chains'	white	Pink tinged rosettes at first, later become pagoda-shaped and turn red
<i>Crassula falcata</i> (airplane plant, propeller plant)	to 60cm (24in)	scarlet	Gray-green foliage with striking texture. Tiny dense clusters of flowers in summer
<i>Crassula ovata</i> (jade tree)	15cm (6in)	white	(syn. <i>C. argentea</i>). Slow growing
<i>Crassula ovata</i> 'Coral'	to 1m (3ft)	white/pink	Unusual deep-green, tubular leaves edged in red. Great bonsai specimen
<i>Crassula perforata</i> (necklace vine)	sprawling	pale yellow	Relatively fast-growing 'stacked' Crassula. Margins often have reddish tinges
<i>Crassula pyramidalis</i> (princess pine)	10cm (4in)	foliage	Named for the tiny scale-like leaves that resemble those of the true club mosses
<i>Echeveria</i> 'Afterglow'		orange/red	Forms wide rosettes of large powdery-pink-lavender leaves edged in bright pink
<i>Echeveria</i> 'Black Knight'	to 15cm (6 in)	red	A dramatic cultivar with very dark-chocolate pointed leaves
<i>Echeveria</i> 'Black Prince'	to 15cm (6 in)	foliage	Slow, low growing succulent, with reddish-brown leaves in triangular shapes
<i>Echeveria</i> 'Domingo' (Domingo hen and chicks)	10cm (4in)	orange	Solitary rosettes of bluish leaves. White waxy cover gives a beautiful blue colour
<i>Echeveria</i> 'Dondo'	7cm (3in)	yellow-orange	Clumping succulent with pointed rosettes pale green leaves, tipped with pink
<i>Echeveria lilacina</i>	7cm (3in)	coral pink	Pale whitish-pink, silver-grey leaves. Slow growing. Flowers on reddish stems
<i>Echeveria minima</i>	7cm (3in)	foliage	Plump silver-grey leaves forming miniature rosettes. Leaves are tipped crimson
<i>Echeveria</i> 'Perle von Nurnberg'		foliage	Deep pink rounded leaves. A stunning cultivar with rosettes to 20cm across
<i>Echeveria prolifica</i>		yellow	Miniature rosettes to 3cm across, offsetting profusely. Silvery green leaves
<i>Echeveria secunda</i> (hen and chicks)		orange/pink	A fast growing, clump-forming succulent. Masses of flowers in summer
<i>Echeveria setosa</i> (Mexican firecracker)	7cm (3in)	yellow-red	Leaves are edged in fine white hairs. Off-sets form large clumps
<i>Echeveria</i> 'Topsy Turvy'	20cm across	orange	Almost tubular, distorted silver-grey, curly leaves covered in a fine white powder
<i>Echeveria</i> 'Violet Queen'	20cm across	foliage	Exquisitely shaped rosettes of silver leaves, curl up slightly to form lotus shape
<i>Fenestraria rhopalophylla</i> (baby toes)	7cm (3in)	white/yellow	Small club-shaped leaves with fenestrate ends form large clumps by offsetting
<i>Gasteria</i> (oxtongue)	to 15cm (6 in)	pink, red, yel	Thick, fleshy, tongue-shaped leaves, often with white, wart-like protuberances
<i>Graptopetalum amethystinum</i> (lavender pebbles)	under 15 cms	magenta-white	Rare species from Mexico that looks more like moon rocks than a plant
<i>Graptopetalum superbum</i> (beautiful graptopetalum)	under 15 cms	foliage	Fleshy, pale gray-lavender to pink-coloured leaves cluster at end of thick stems

SUCCULENTS AND CACTI

Plant Name	Height	Colour	Information
<i>Graptoveria</i> 'Alpenglow'	under 15 cms	foliage	Beautiful pink-mauve leaves in rosettes that become somewhat bushy
<i>Graptovaria</i> 'Debbie'		apricot	Lanceolate, frosty-pink leaves arranged in a rosette. Porous soil
<i>Graptoveria</i> 'Fred Ives'	30cm (12in)	white	Stiff pink to orange leaves form wide rosettes. Beautiful, mass planted in large pot
<i>Graptoveria</i> 'Opalina'	to 20cms (8in)	yellow-orange	Produces clusters of tight rosettes with a hint of mauve-purplish tones in sun
<i>Haworthia attenuata</i>	under 15 cms	white-green	Dark green, pointed leaves, strikingly banded or spotted
<i>Haworthia cooperi</i>	5cm (2in)	foliage	Pale green leaves with terminate bristle
<i>Haworthia cuspidata</i>	5cm (2in)	foliage	Charming plant with chunky lime green rosettes. Does well on a window sill
<i>Haworthia retusa</i>	under 10cms	white	Rosettes of very thick, triangular, translucent green leaves
<i>Kalanchoe daigremontiana</i> (thousand mother's plant)	under 50cms	greyish-pink	Upright succulent with triangular-lance-shaped, grey-green leaves, spotted brown
<i>Kalanchoe fedtschenkoi</i> 'Variegata'	30cms (12in)	foliage	Lavender gray-green leaves & cream coloured varieg. on scalloped leaf margins
<i>Kalanchoe tomentosa</i> (panda plant)	25cms (10in)	foliage	Grown for the interesting furry foliage
<i>Kalanchoe beharensis</i> 'Fang'	to 60cm (24in)	foliage	Leaves covered with dense white hairs, and undersides are highly textured
<i>Pachyphytum clavifolia</i> (syn. <i>Pachyveria clavifolia</i>)	under 15 cms	foliage	Grey-green leaves in somewhat untidy rosettes
<i>Pachyphytum compactum</i>	under 15 cms	foliage	Thick rounded, triangular leaves heavily veined with white, tipped with deep purple
<i>Pachyphytum oviferum</i> (moonstones)	under 15 cms	scarlet	Leaves are covered with a blue-white bloom
<i>Peperomia nivalis</i>	trailing	foliage	May be either rosette-forming or erect with trailing stems
<i>Portulacaria afra</i> (porkbush, elephant's food)	to 1.5m (5ft)	foliage	Similar in appearance to the jade plant, with smaller pads & more compact growth
<i>Sedeveria</i> 'Blue Mist'	trailing	golden/yellow	Cascading succulent with stems to 5cm. Good for hanging baskets
<i>Sedeveria</i> 'Harry Butterfield' (super burro tail)	trailing	foliage	Grows into long chains which tip over and hang like an animal's tail
<i>Sedeveria</i> 'Hummeli'	under 10 cms	yellow	Cross between <i>Sedum</i> and <i>Echeveria</i> . Attractive blue-green colouring with red tips
<i>Sedeveria</i> 'Jet Beads'	under 10 cms	yellow	Succulent green rosettes are tipped with dark purplish-black. Unusual hybrid
<i>Sedum clavatum</i>	under 15 cms	white	Frosty blue-green leaves tend to elongate to form creeping stems in time
<i>Sedum morganianum</i> (burro's tail)	trailing	foliage	Trailing plant with wiry stems covered with short thick silvery-lime-green leaves
<i>Sedum nussbaumerianum</i>	under 15 cms	white	Adds a brilliant coppery colour to your rock garden
<i>Sedum rubrotinctum</i> (blue jelly bean plant)	under 10 cms	yellow	Interesting succulent plant with jelly-bean-like leaves
<i>Sedum rubrotinctum</i> 'Aurora' (pink jelly beans)	under 15 cms	foliage	Leaves are pale green tinged pink, especially when grown in bright light
<i>Senecio rowleyanus</i> (string of pearls)	trailing	foliage	Plant 'string of pearls' succulent in a hanging basket for best effect
<i>Senecio serpens</i> (blue chalk sticks)	trailing	white	Trailing groundcover-type plant with succulent, blue-green, cylindrical foliage

The maple tree was officially recognized as Canada's official tree emblem in 1996 but its leaf has been an emblem in Ontario and Quebec since 1868. There are ten species of maple tree native to Canada and at least one species is native in every province. The maple leaf on Canada's flag is stylized from these many species. In British Columbia, there are three native maples: vine maple, *Acer circinatum*; Douglas maple, *Acer glabrum*; and big-leaf maple, *Acer macrophyllum*. There are maples for sale in the Trees and Shrubs Section and the Pacific Northwest Native Plant Section of the Plant Sale.

VANDUSEN PLANT SALE

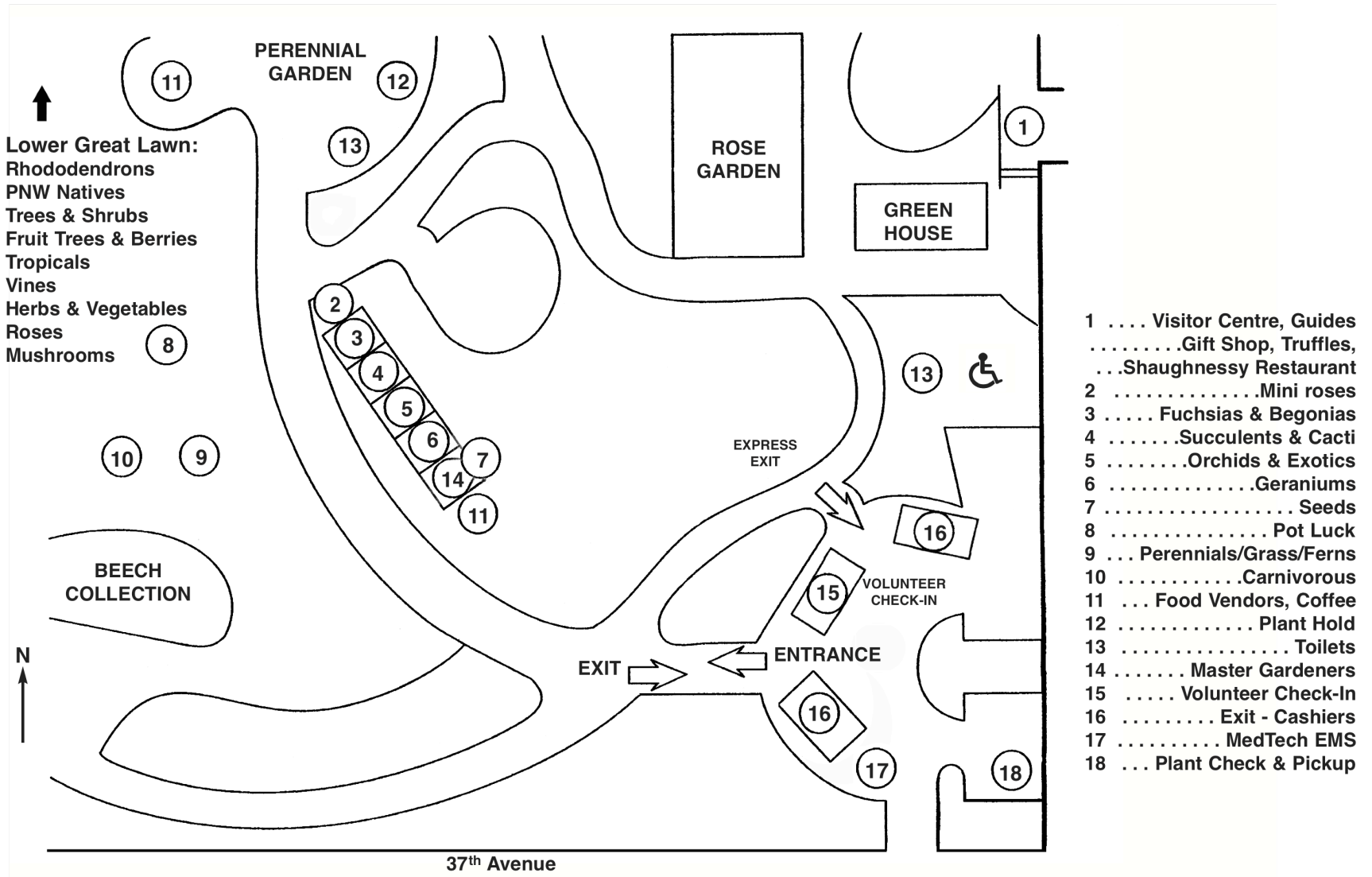

Plant Hold (#12). Store your plants in this secure area while you continue to select plants or enjoy a stroll in the garden.

Plant Check and Pickup (#18). If you do not wish to carry your plants to your car, leave them in this secure area in the parking lot. Volunteers will give you a pass allowing you to bring your car into the parking lot. Trays, boxes and wheelbarrows are supplied to assist in carrying your purchases.